

**Wall cladding.
Impact edges/bumper rails.**

Design

interior



ATHLON

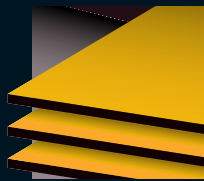

TRESPA

All the best qualities in one panel

Contents

<i>General information</i>	3
Product data Trespa Athlon	4
Applications and delivery programme	5
Trespa Athlon	6
<i>Wall cladding</i>	7
Characteristics	7
Moisture regulating fixing system	8
Joints	9
Corner solutions	10
Fixing systems	11
Visible fixing with screws	12
Blind fixing with screws or inserts	15
Blind fixing with continuous integrated panel bracket	19
Blind fixing with adhesive	25
Semi-blind fixing with joint profile or metal tongues	28
<i>Applications</i>	31
Bathrooms/sanitary units	31
Bumper rails	33
Bumper rails combined with Trespa Athlon	
round-cornered element	34
Trespa Athlon bumper rails combined with banister	35
<i>Fixing methods</i>	36

General information.

Trespa Athlon is

- a high quality panel material from Trespa International BV
- specially developed for durable interior fittings
- flexible and functional in a wide range of architectural applications
- technically of high quality
- economical
- ecological.

Product data Trespa Athlon.

Material properties Trespa Athlon

Properties	Value	Unit	Standard
Physical properties			
Specific gravity	± 1.400	kg/m ³	ASTM-D 792-91
Weight	Thickness 6 mm	8.5	kg/m ²
	Thickness 13 mm	18.5	kg/m ²
	Thickness 16 mm	22.5	kg/m ²
	Thickness 20 mm	28.0	kg/m ²
Panel tolerance			
Length & Width	- 0.0/+5	mm	
Thickness	± 0.5 for 6,8,10	mm	
	± 0.6 for 13,16	mm	
	± 0.7 for 20	mm	
	± 0.8 for 25	mm	
Optical properties			
Changes when subjected to dry heat (maximum temperature of 180°C)			EN 438-2 (26)
gloss	5 (= no changes)		
colour	5 (= no changes)		
cracking	5 (= no changes)		
Mechanical properties			
Modulus of elasticity	≥ 10.000	N/mm ²	DIN 53457
Tensile strength	≥ 70	N/mm ²	DIN 53455
Flexural strength	≥ 100	N/mm ²	DIN 53452
Surface impact resistance	4	Index number	EN 438-2 (11)
Scratch resistance			
Plain colours, light	4	Index number	EN 438-2 (14)
Plain colours, dark	3	Index number	EN 438-2 (14)
Wear resistance			
All plain colours	3	Index number	EN 438-2 (6)
Fantasy decors	2	Index number	EN 438-2 (6)
Water absorption	≤ 1.0	% weight	EN 438-2 (7)
Dimensional stability	≤ 2.5	mm/m	
Thermal properties			
Thermal conductivity coefficient ± 0.3		W/mK	DIN 52612
Application temperature			
- constant	-40 to 130	°C	
Chemical properties			
See datasheet chemical properties			
Fire behaviour			
Great Britain	Type FR: class 0		BS 476 Parts 6-7
Fire classification	Type Standard: class 2		Building Regulations
The Netherlands	Type FR: Klasse 1		NEN 6065
Brandklasse	Type Standard: Klasse 2		NEN 6065
Germany	Typ FR: Klasse B1		DIN 4102
Baustoffklasse	Typ Standard: Klasse B2		DIN 4102
France 6-8-10-13-16-20 mm	Type FR: Classement M1		NF P 92-507
	Type Standard: Classement M3		NF P 92-507
Belgium	Type FR: Klasse A1		NBN S21-203
	Type Standard: Klasse A2		NBN S21-203

Applications and delivery programme.

Form and compilation

Trespa Athlon is a flat decorative panel based on thermosetting resins, homogeneously reinforced with cellulose fibres and manufactured under high pressure and temperature. Using special techniques, the panels have an integrated, decorative surface made of melamine impregnated paper. Trespa Athlon complies with the European standard EN 438.

Trespa Athlon is specially developed for durable interior fittings. The panel is resistant to scratches, wear, moisture and to a large degree resistant to chemicals.

Trespa Athlon is often used for:

- project furniture
- wall cladding in bathrooms and treatment rooms
- cleanrooms such as operating theatres, laboratories, production rooms for foodstuffs, pharmaceuticals, cosmetics, electronic equipment etc.
- bumper rails
- changing cubicles, lockers
- wall cladding and party walls for showers and sanitary units
- laboratory furniture

Trespa Athlon is often used in:

- offices
- hotels
- universities and teaching institutions
- sports and recreation centres
- camp sites
- food industry
- hospitals
- care and nursing centres
- public buildings

The product programme

Sizes:

- 3050 x 1530 mm
- 2550 x 1860 mm

Thicknesses:

6, 8, 10, 13, 16 and 20 mm

Colours:

- more than 36 primary and pastel plain colours
- 16 speckled decors (Futuriq)
- 21 fantasy decors (Imagiq: Nuages, Fibres, Craquelee) and 6 wood decors (NaturiQ).

Surface structures:

- Quartz: a surface structure with a flowing, even texture, recommended for vertical applications.
- Crystal matt: a very fine surface structure with a matt gloss, recommended for horizontal applications.

Types:

- Standard - black core
- Fire resistant (FR) - brown core.

Trespa Athlon is also available as corner profiles or postformable panels.

Further information

We will be pleased to send you a detailed delivery programme and/or extensive colour documentation.

Trespa Athlon.

The excellent mechanical and surface properties of Trespa Athlon make this panel ideal for use as wall cladding in damp rooms, or rooms which require intensive cleaning. Trespa Athlon is not adversely affected by moisture and is not susceptible to weathering, mould or rot. Dirt cannot cling to the non porous surface and the closed core, so the material is easy to clean and disinfect - even using weak solutions.

The panel material can be sawn, routed and drilled with the usual tools for hardwoods. There is no requirement to finish the edges because of the closed, impact-resistant core.

Trespa Athlon conforms to the requirements of the FDA (Food and Drugs Administration) for use in the food industry. The panel material can come into direct contact with foodstuffs during preparation and preservation without any problems.

According to DIN 51953, Trespa Athlon is classed as an anti-static material. This makes the panel ideal for applications in areas such as clean rooms, the optical industry and as computer furniture.

Trespa is penetrated by X-rays and is therefore often used in the medical and nursing sector.

Trespa Athlon is easy to install. It can be fixed visibly, semi-blind or blind with the invisible fixing offering high pull-out resistance. The panel material does not cause corrosion of the fixings.

It may be necessary to fit supply and wiring systems in the wall construction. These can be concealed behind the panel.

Trespa Athlon, in combination with suitable insulating materials, is well suited as dividing elements in rooms which require good noise and heat insulation and high fire resistance. Trespa Athlon (Crystal Matt and Quartz) is highly resistant to burning cigarettes. They do not damage the surface and leave no permanent marks. The fire behaviour of both types of Trespa Athlon is comparable to that of hardwood. The panel material does not melt, drip or explode and retains its stability for a long time.

The fire resistant type (FR) has been classed by several European test institutes in the best class for fire behaviour of organic material.

In France this type has also been tested according to the standards NFX 70 100 and NFX 10 702 for emissions of toxic and corrosive gases. The result of these tests is the F1 classification, the most favourable class for organic building material.

Incineration in industrial furnaces (temp. > 720° C) will not release harmful, corrosive gases and results in an energy recovery of approximately 18 GJ/1,000 kg of Trespa Athlon.

WALL CLADDING

Characteristics.

Trespa Athlon is often fitted as a so-called suspended cladding element.

This means that the material is assembled on a supporting subframe.

The panel is fixed visibly with screws or invisibly with the help of an aluminium construction or glue on a wall or structure behind the panel. This wall or structure can consist of timber, steel or aluminium vertical and horizontal battens, either unfinished or finished with for instance plasterboard, or it may be a solid brick or concrete wall. The most commonly used fixing method for Trespa Athlon panels in interior applications is blind fixing. The drawings opposite give a general impression of the various fixing methods.

- A.** Wall cladding on vertical and horizontal battens.
- B.** Wall cladding on metal vertical and horizontal battens.
- C.** Wall cladding on metal vertical and horizontal battens with plasterboard.
- D.** Wall cladding on solid wall.
- E.** Installation cladding with self-supporting subframe.

- 1. Trespa Athlon panel 8 mm
- 2. Trespa Athlon panel 6 or 8 mm
- 3. Aluminium auxiliary construction.
- 4. Vertical batten
- 5. Vertical timber battens
- 6. Insulating material
- 7. Cables
- 8. Solid wall
- 9. C section
- 10. Plasterboard
- 11. Box section
- 12. Adhesive system

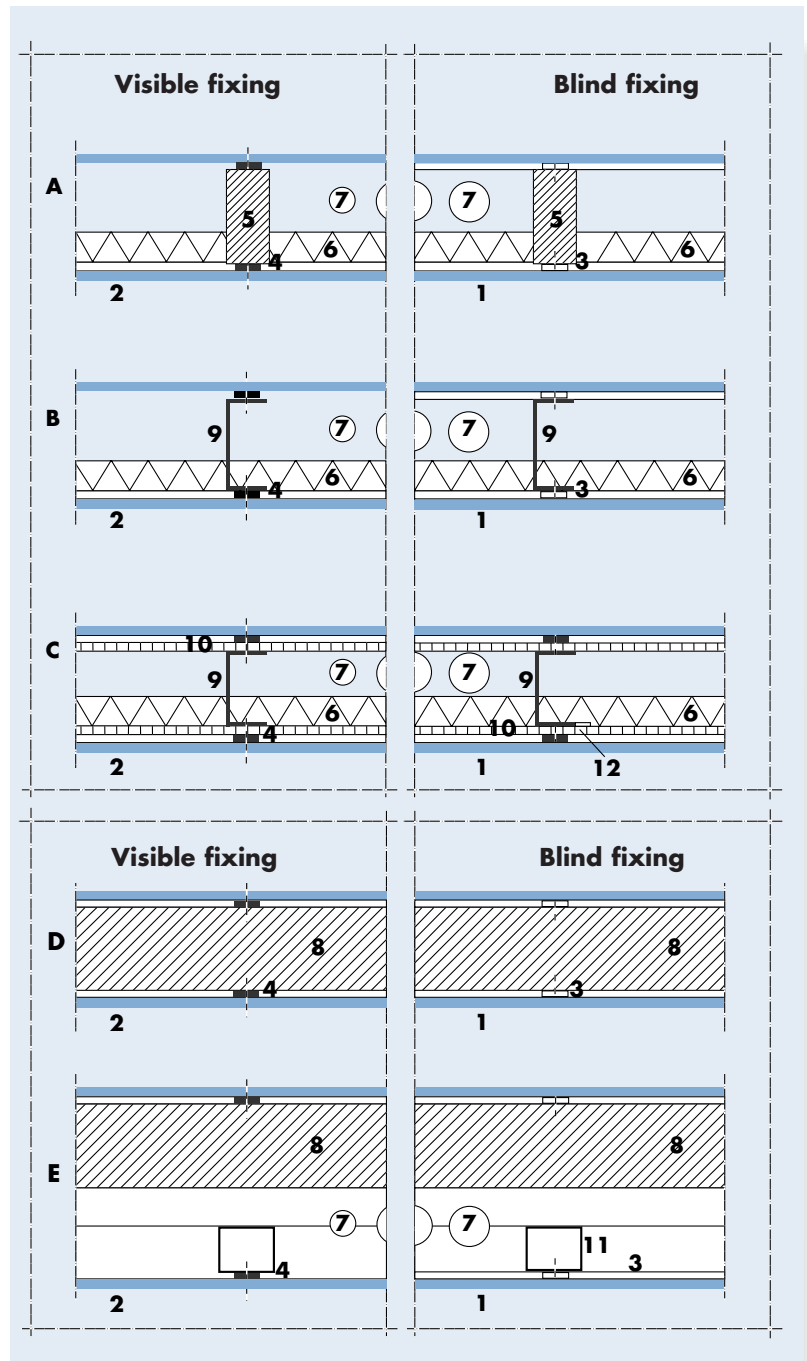

Moisture regulating fixing system.

Apart from being used as wall cladding, Trespa Athlon is also used for installation cladding, column cladding and as bumper rails. Special fixing systems for such applications are shown in the relevant drawings. The details given are not specific, but they demonstrate the general principle.

The main details in the following sections differentiate between fully back ventilated and semi-sealed wall cladding. The difference between the two is apparent in the vertical cross-sections. The difference in the horizontal cross-sections is simply whether or not the joints are sealed with mastic.

In the case of damp subframes such as new masonry, new plasterwork, damp walls made of concrete, etc., extra ventilation must be provided until the relative moisture on both sides of the construction is equal.

A. Fully back ventilated wall cladding.

The Fully back ventilated wall cladding is distinguished by:

- open floor and ceiling connections
- horizontal or vertical profiles mounted to provide spacing.

B. Semi-sealed wall cladding.

The semi-sealed wall cladding is distinguished by:

- the interconnected open space between the rear wall and the space above the (system) ceiling.
- the horizontal profiles mounted to provide spacing
- the closed joints, e.g. ceiling and floor connections.

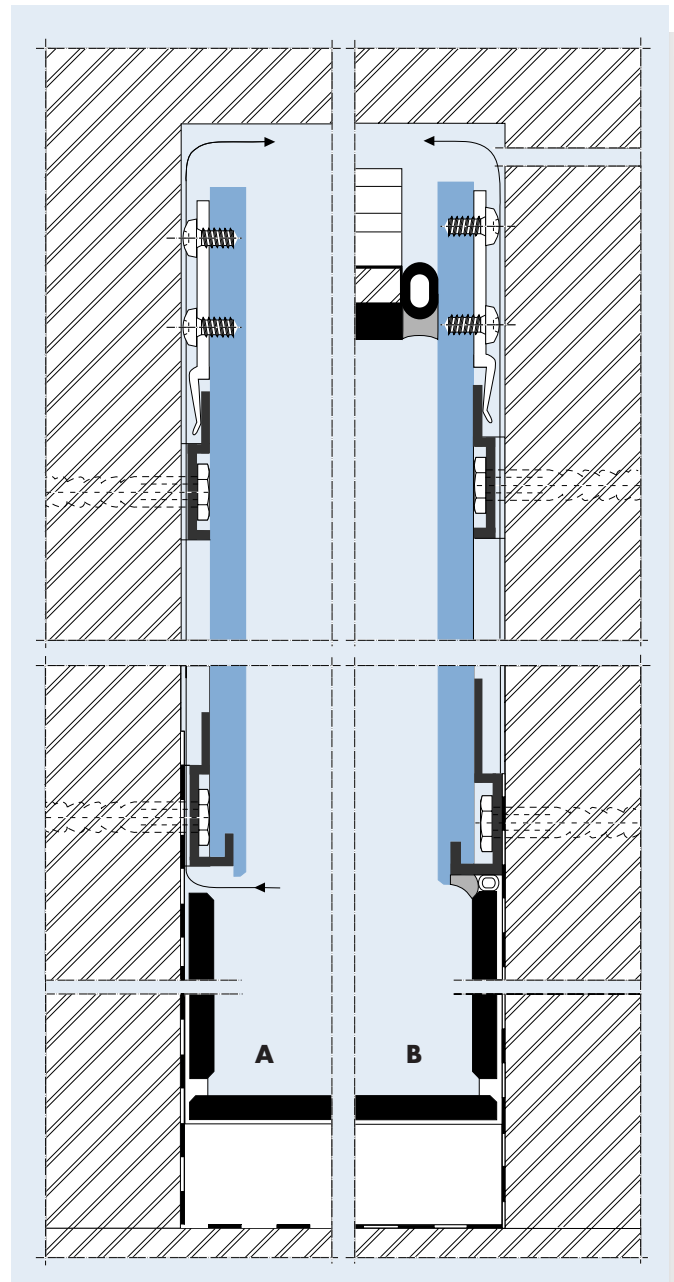

A. Fully back ventilated wall cladding.
Vertical cross-section

B. Semi-sealed wall cladding. Vertical cross-section

Joints.

In view of possible changes in size as a result of moisture and temperature changes, joints should be left free both for vertical and horizontal connections in such a way that the panel material can move by 2.5 mm/m¹ maximum. Thanks to the excellent workability of the material, it is possible to precisely seal vertical and horizontal joints without auxiliary profiles. For panel thicknesses from 8 mm upwards it is possible to make joints in the form of rebated joint connections or as tongue and groove connections.

Horizontal joints

Either tongue and groove connections or rebated joint connections can be used for horizontal joints. The joint must be made in such a way that the panels can move by 2.5 mm/m¹ maximum. The recess in the rebated joint must measure at least 2 x the joint width.

Vertical joints

The tongue and groove connection can be used for vertical joints. The panel thickness left on each side of the groove must be at least 2.9 mm. If a Trespa Athlon groove is used, the panel thickness must be 10 mm. If an aluminium groove is used, a panel thickness of 8 mm is sufficient.

Joint sealing using mastic.

When Trespa Athlon is used for interior applications where high standards of hygiene and disinfection are required, wall constructions with airtight seals are often chosen. The joints are then sealed with an elastic mastic. This sealing material must be mould repellent (ISO 846) and resistant to disinfectants, if it is used in the aforementioned applications. What's more it is necessary for the adhesion between the sealing material and the panel to withstand draughts, damp, dust and dirt. It is recommended to use Trespa Athlon in combination with silicone mastic or polyurethane.

Important guidelines for applying elastic sealing material:

- The joint must be absolutely clean, dry and free of grease.
- If necessary, a primer must be used to facilitate adhesion.
- The sealing material must on no account adhere to the reverse side (adhesion on three sides) because this can cause cracking. It is advisable to use a separating film or polyethylene tongue.
- To ensure that the sealing material is not under excessive strain, the joint must be sufficiently wide and the depth of the joint should not be greater than the width of the joint.

- If the joints turn out to be too deep, then a backing which is appropriate for the sealing material must first be applied.

For specific processing instructions, see the guidelines provided by the relevant supplier.

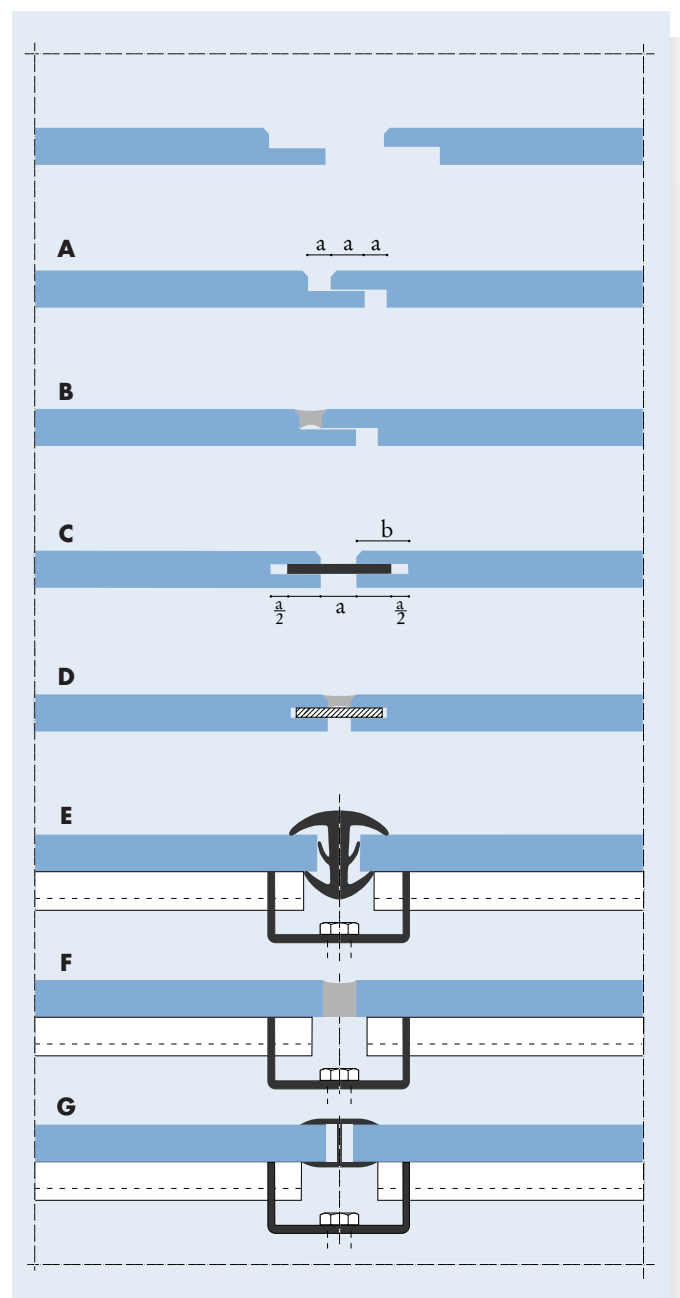

a ≥ 8 mm
b ≥ 15 mm

A, C and G: For damp rooms

B, D, E and F: For clean rooms such as operating theatres.

Corner solutions.

Flat panel

When joining Trespa Athlon panels in a corner it is important to take account of the movement of the panel. To avoid tension in the joint it is advisable to keep the leg length of the corner element as small as possible (at most 400 mm).

From a panel thickness of 8 mm upwards, prefabricated corner elements are available.

Adhered connections must always be combined with a mechanical connection. A 2-component polyurethane glue can be used to adhere Trespa Athlon parts together. The parts to be adhered must have the same "grain direction" (both cut from the length or from the width of the panel).

The recommended solution for impact-absorbing applications such as bumper rails is an external corner as shown in detail **A**. If the solution shown in detail **F** is used, the outer corner must be well faceted.

Postforming

Using the modified Trespa Athlon panel it is possible to make almost unlimited "individual" corner solutions in various sizes and radii ($R > 15$ mm).

Trespa Athlon corner profiles

These are the ideal solution for particularly difficult applications or where a decorative effect is required on both sides. Corner elements are available in a length of 3050 mm and 1860 mm with an outer radius of 20 mm and a leglength of 300 mm.

Trespa Athlon panels can also be joined together in corners in various other ways:

- glued aluminium or plastic corner profile
- glued aluminium or plastic tongue
- tongue and groove joint with support

- A.** Trespa Athlon corner profile, inner and outer corner
- B.** Subsequently shaped inner corner
- CD.** Subsequently shaped outer corner
- EF.** Compound outer corner
- GH.** Compound inner corner

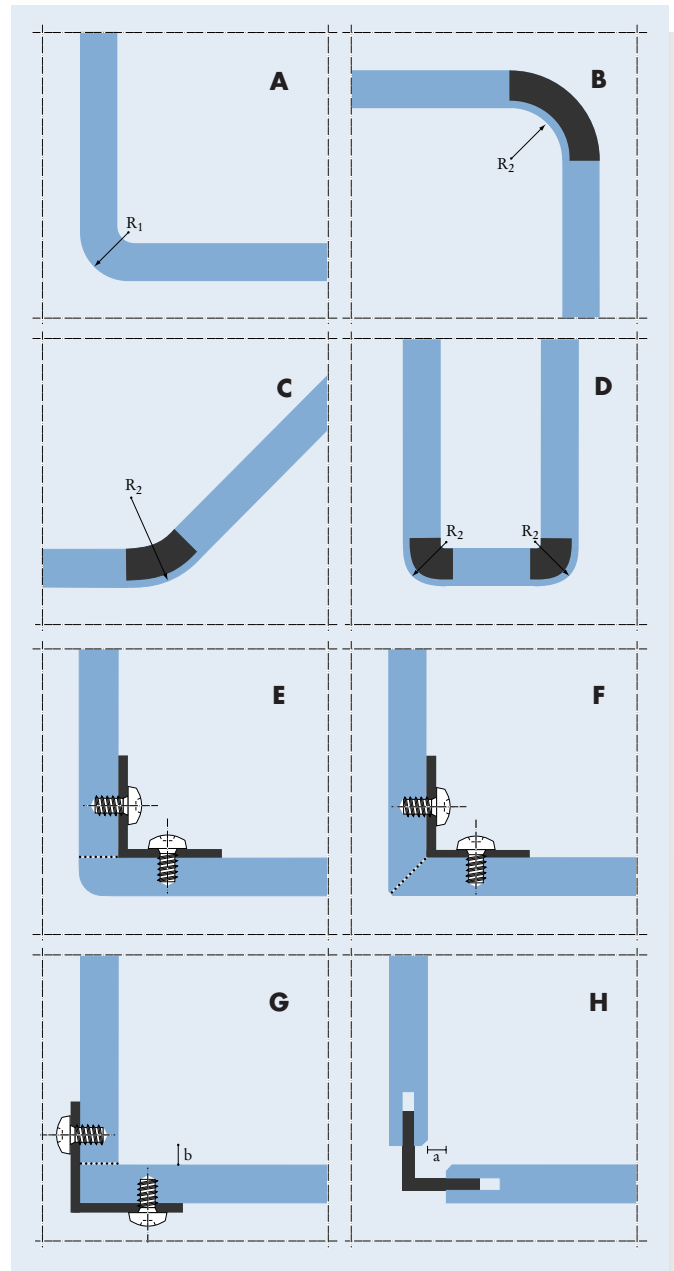

- $a \geq 4$ mm
- $b \geq 5$ mm
- $R_1 = 20$ mm
- $R_2 \geq 15$ mm

FIXING SYSTEMS

General guidelines

Trespa is fitted to a suitable subframe with corrosion resistant devices in such a way that the panels are not subjected to tension and cannot work loose as a result. It is important when determining the subframe to take account of the following points:

- the load-bearing requirements
- maximum fixing distances for the panels
- the necessary ventilation or moisture regulating provisions
- the unrestricted ability of the panels to move
- the available panel sizes
- the thickness of any insulating layer
- the anchoring options in the building (wall) construction
- legal requirements

Fixing

The following methods can be used for fixing Trespa panels. It is also possible to vary or combine the methods. The drawings in this brochure illustrate the principles of the fixing systems, but do not indicate particular brands.

- visible fixing with screws
- blind fixing with screws or inserts
- blind fixing with continuous integrated panel brackets
- blind fixing with adhesive
- semi-blind fixing with metal tongues or joint profiles

Visible fixing with screws.

Installation

Visible fixing is used for panels with a thickness of 6 or 8 mm. Panels with a thickness of > 8 mm can be fixed invisibly.

It is extremely important when fixing panels to ensure that they can move freely and evenly. The diameter of pre-drilled holes must be at least 3 mm greater than the screw diameter. Screws with countersunk heads must not be used, as they restrict the ability of the panels to move. The screw must be properly centered in the drillholes.

From a panel thickness of 8 mm upwards, a recessed screw can be used, possibly covered with a plastic cap flush with the face of the panel (diagram A). It is also possible to use the quick assembly screws designed for Trespa. The drillhole diameter must then be 8 mm (diagram B). The screw must be perfectly centered.

General remarks

Joints: at least 8 mm

Panel thickness: from 6 mm upwards

Fixing and edge distances

- a. horizontal and vertical fixing distance (see table)
- b: edge distance
 - min. 20 mm
 - max. 10 x panel thickness

Maximum fixing distances:

Panel thickness	2 fixing points in one direction	3 or more fixing points in one direction
8 mm	550 mm	700 mm
10 mm	700 mm	850 mm

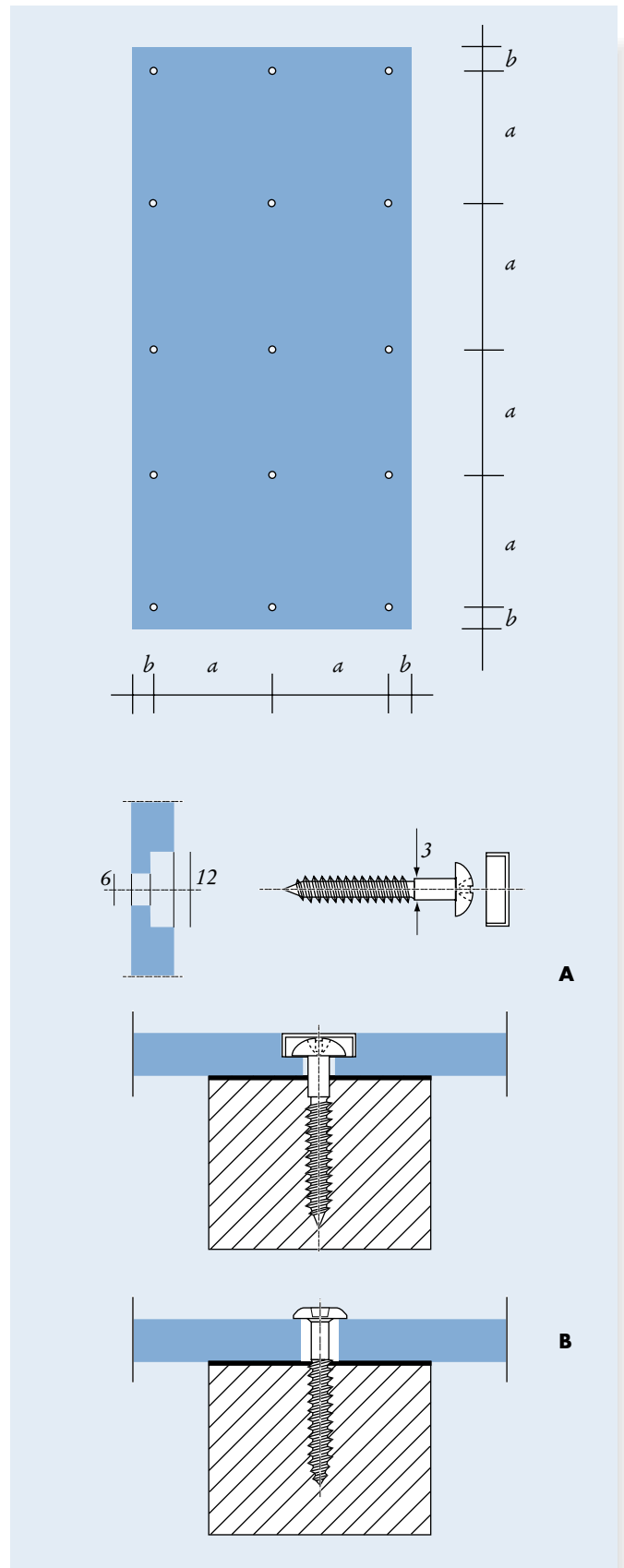

Visible fixing with screws.

Horizontal cross-section

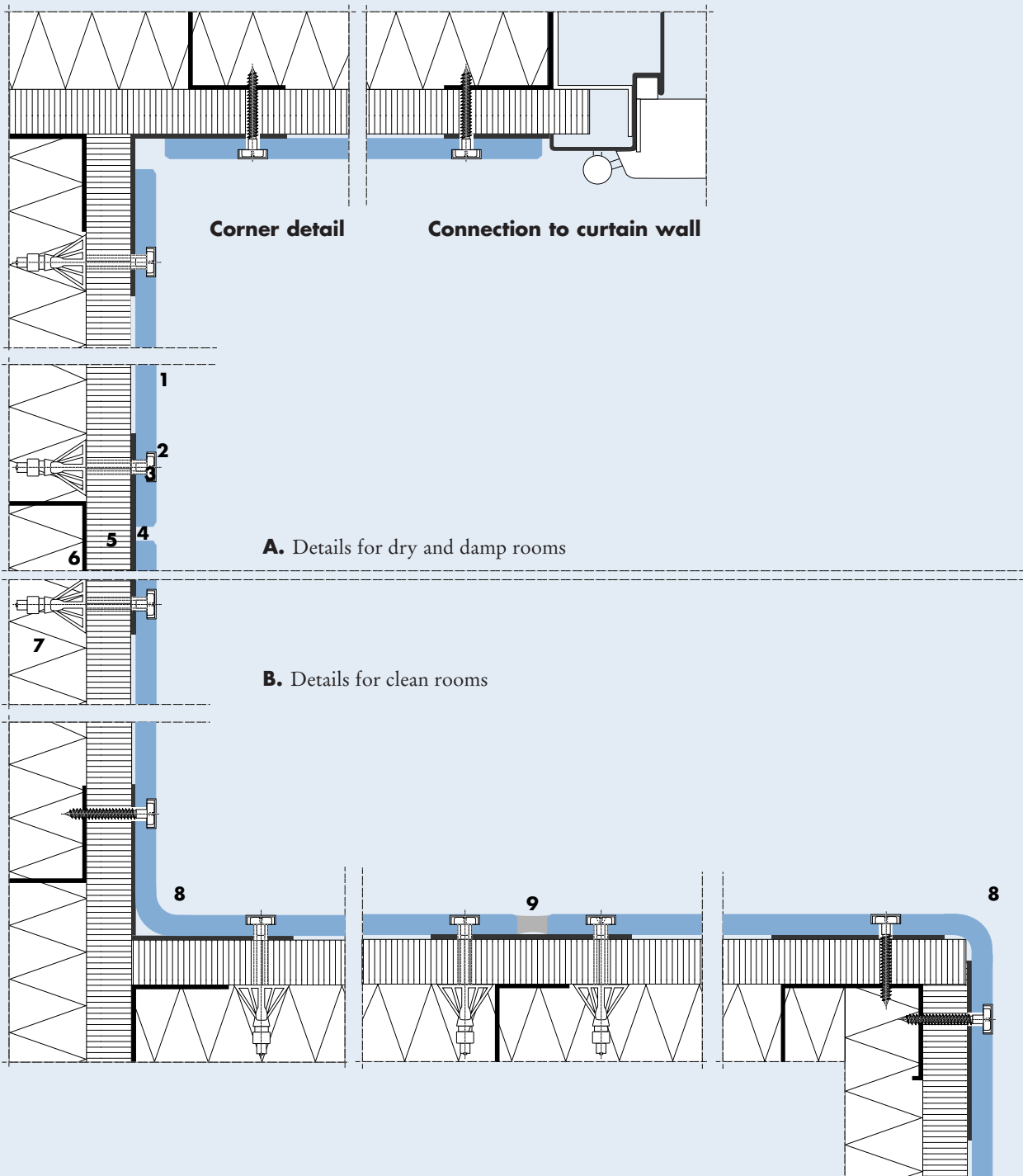

1. Trespa Athlon
2. Plastic cap
3. Cavity wall fixing

4. Spacer ≥ 3 mm
5. Plasterboard
6. [-profile

7. Insulating material
8. Trespa curve
9. Mastic joint

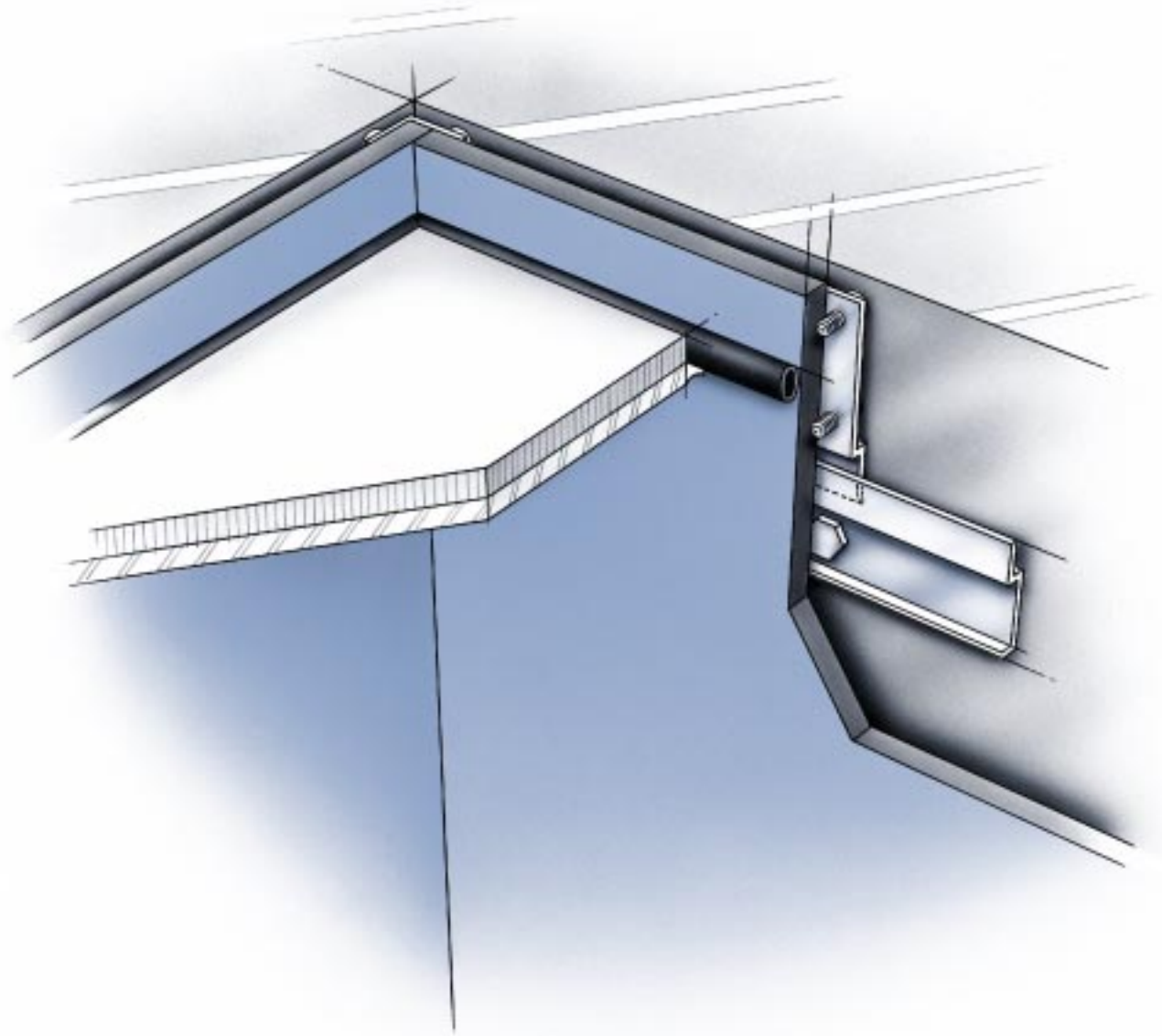

Blind fixing with screws or inserts.

Installation

Trespa Athlon panels with a thickness of > 8 mm can be fixed invisibly. This is often done using thread-cutting screws, inserts and bolts in a pre-drilled hole. It is best to pre-drill using a depth stop so that a residual thickness of at least 2 mm remains on the visible side of the panel.

Installation using panel brackets and horizontal supports

There are various systems for invisibly fixing Trespa Athlon panels. Each one is based on the principle that the panel must be able to move in relation to the subframe. These systems consist of brackets or continuous profiles fixed to the reverse side of the panel which engage with horizontal battens mounted on the wall.

The advantage of these systems is that the panels can be quickly and easily dismantled, which is important, for example, when supply and wiring systems are extended/renewed.

General remarks

Joints at least 8 mm

Panel thickness from 8 mm upwards

Length of leg of corner panels maximum 300 mm, otherwise a fixing point must be provided near the corner of the element.

Fixing and edge distances

o = panel bracket fixing

a = horizontal fixing distance (see table)

b = edge distance:

Maximum fixing distances:

Panel thickness	2 fixing points in one direction	3 or more fixing points in one direction
8 mm	550 mm	700 mm
10 mm	700 mm	850 mm
13 mm	850 mm	1000 mm

Fixing details

Fixing means*:

- insert
- thread-cutting screw
- tension-free insert

Anchoring depth: panel thickness - 3 mm

Remaining panel thickness: at least 2 mm

* See also chapter "Fixing means"

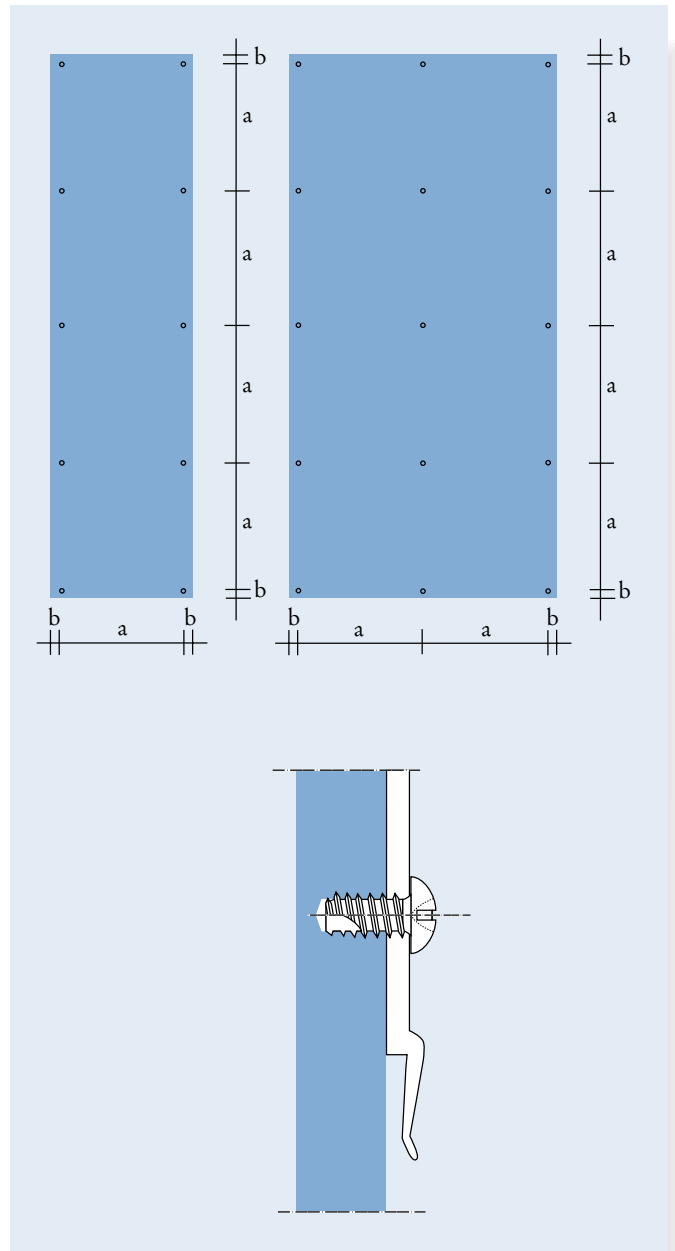

Blind fixing with screws or inserts.

Horizontal cross-section

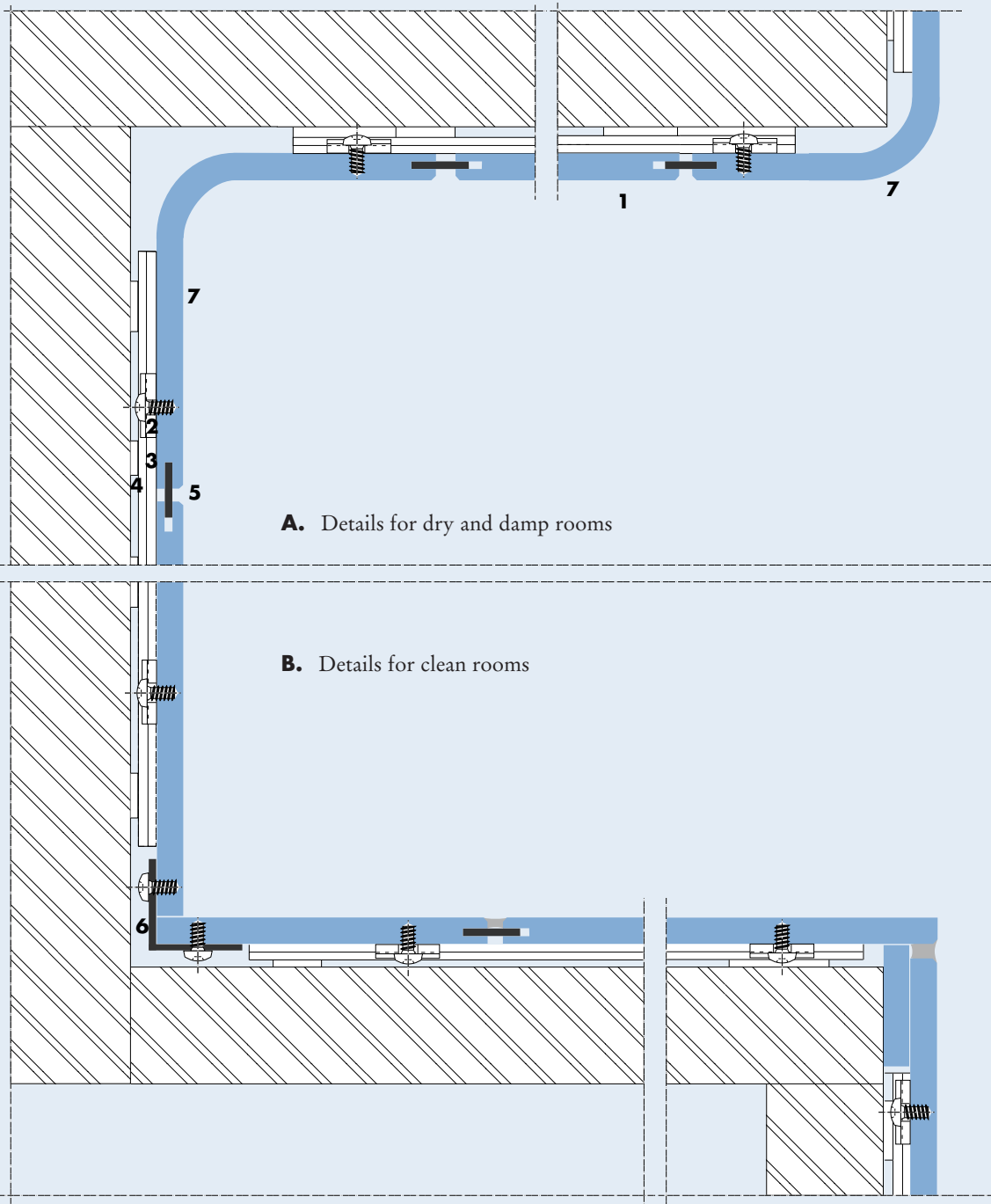

A. Details for dry and damp rooms

B. Details for clean rooms

- | | |
|--------------------------------------|--|
| 1. Trespa Athlon ≥ 8 mm | 5. Joint ≥ 8 mm |
| 2. Panel bracket | 6. Aluminium corner profile |
| 3. Horizontal support profile | 7. Trespa Athlon corner profile ≥ 8 mm |
| 4. Spacer ≥ 3 mm | |

Blind fixing with screws or inserts.

Vertical cross-section

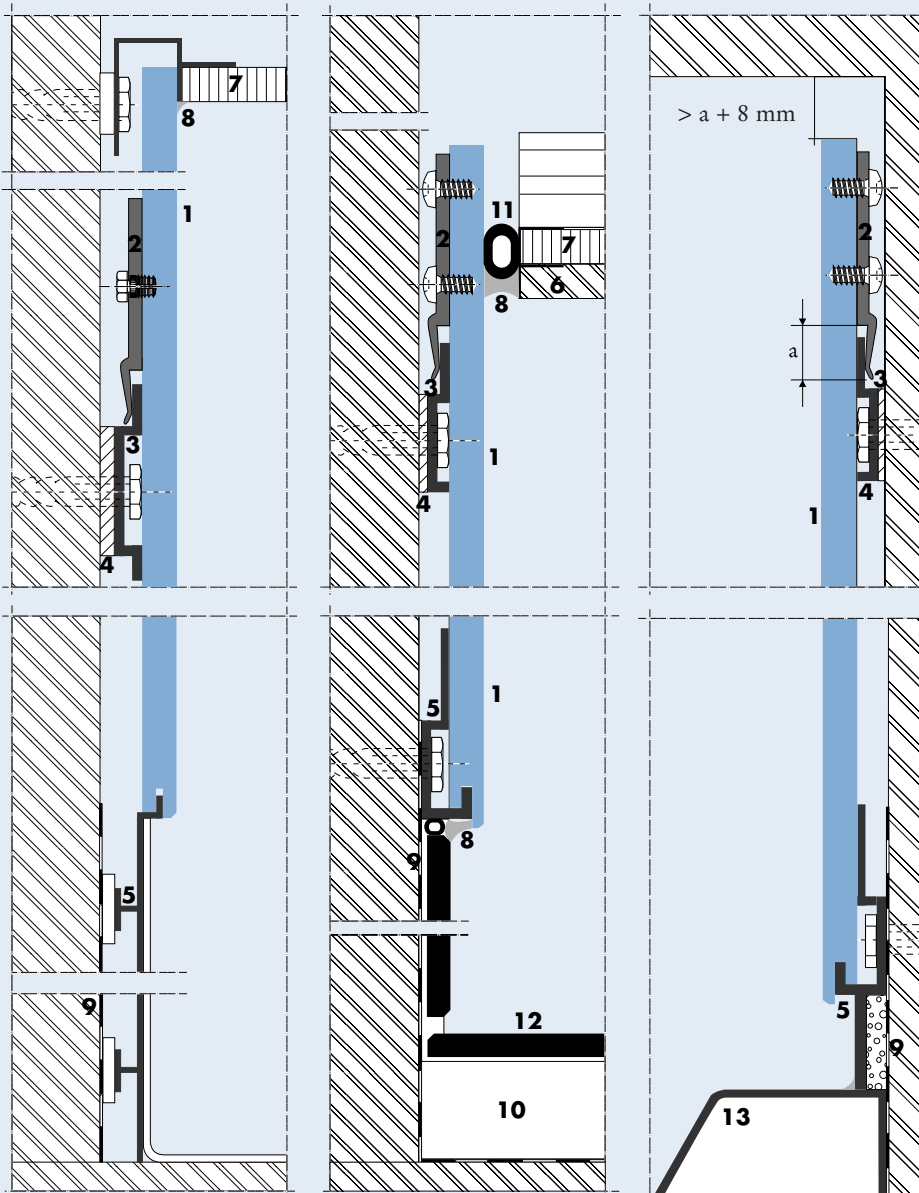

- | | |
|--|-----------------------------|
| 1. Trespa Athlon panel ≥ 8 mm | 7. Plasterboard |
| 2. Panel bracket | 8. Mastic joint |
| 3. Horizontal support profile | 9. Moisture repellent layer |
| 4. Spacer next to the fixing of the horizontal support profile | 10. Floor finish |
| 5. Lower horizontal batten | 11. Rubber profile |
| 6. Plaster layer | 12. Tiled floor |
| | 13. Edge of bath |

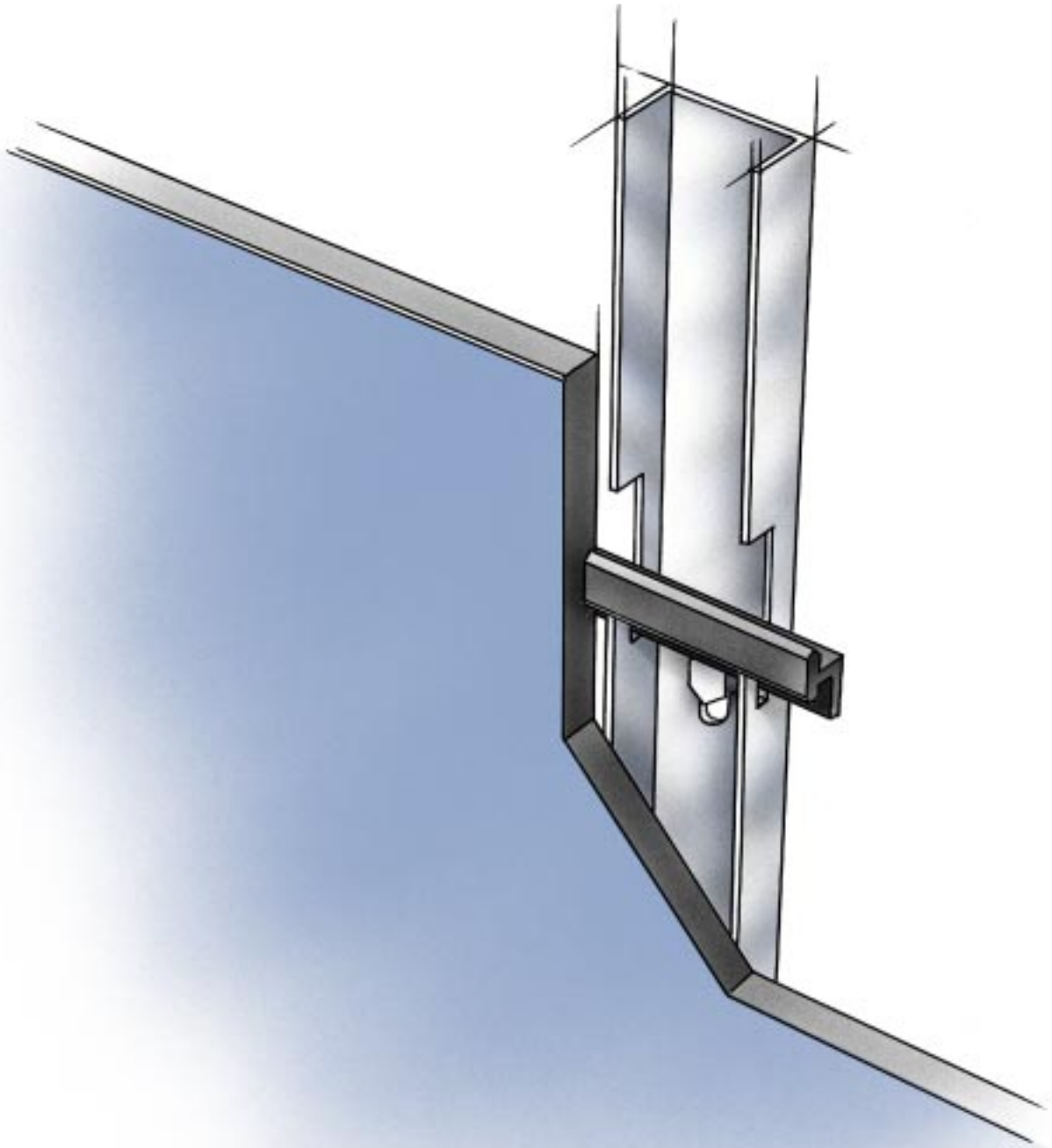

Blind fixing with continuous integrated panel bracket.

The continuous panel bracket is integrated in the Trespa Athlon panel by means of milling. This results in an ideal mechanical connection which optimally preserves the panel properties.

The fixing system has a number of important advantages:

- very easy and quick to install
- the continuous panel bracket is integrated in the Trespa Athlon panel by means of milling
- light construction, so a thin panel is possible

Maximum fixing intervals <i>a</i> (in mm)	Panel thickness (in mm)		
	8	10	13
2 fixing points in one direction	600	750	950
3 or more fixing points in one direction	750	900	1200

General remarks

Joints: at least 8 mm

Panel thickness: from 8 mm upwards

Fixing and edge distances

a = horizontal fixing distances

b = edge distance: 72 mm

c = vertical fixing distance: 600 mm

Milling

The milling in the rear side of the Trespa Athlon panel is made with a special milling tool.

Vertical support profiles must be positioned exactly.

NOTE: the blind fixing with continuous integrated panel bracket is not suited for rooms with a constant high relative humidity ($\geq 90\%$) or a wet application.

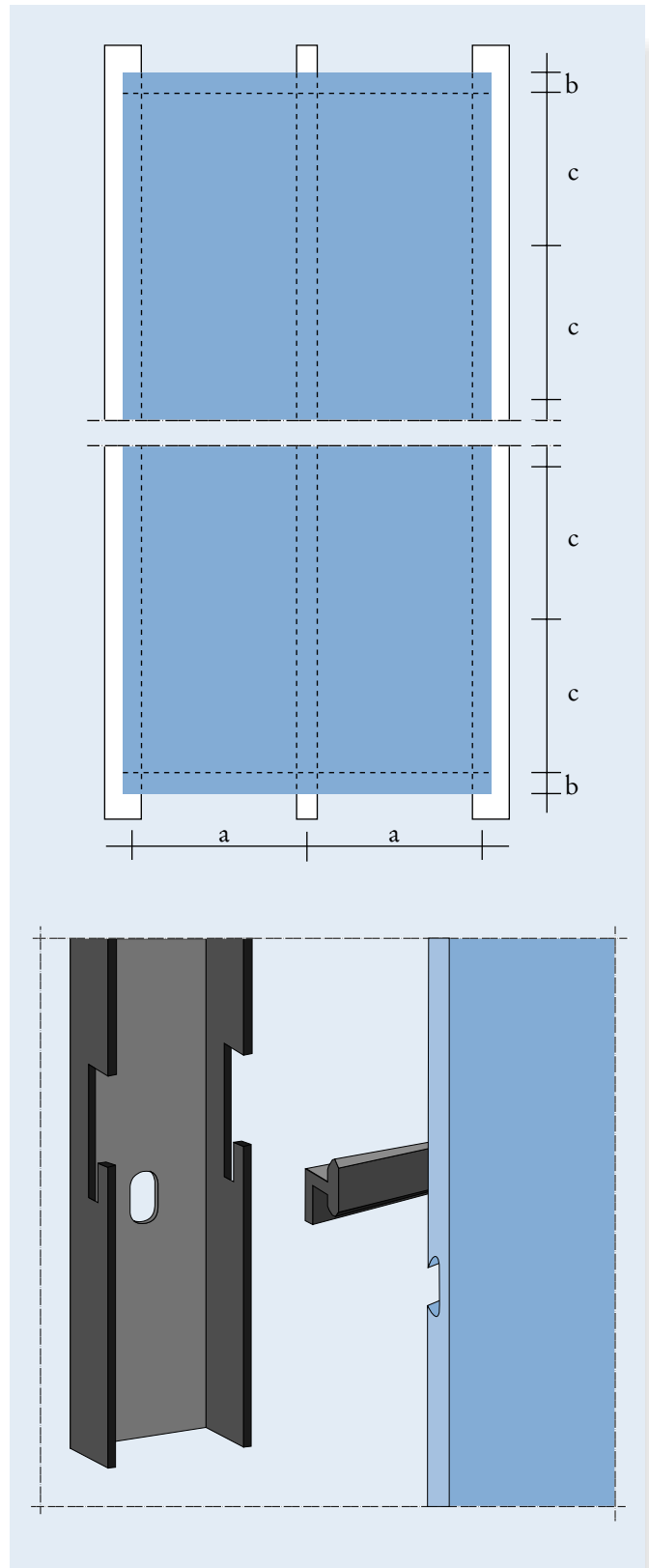

Blind fixing with continuous integrated panel bracket.

Horizontal cross-section

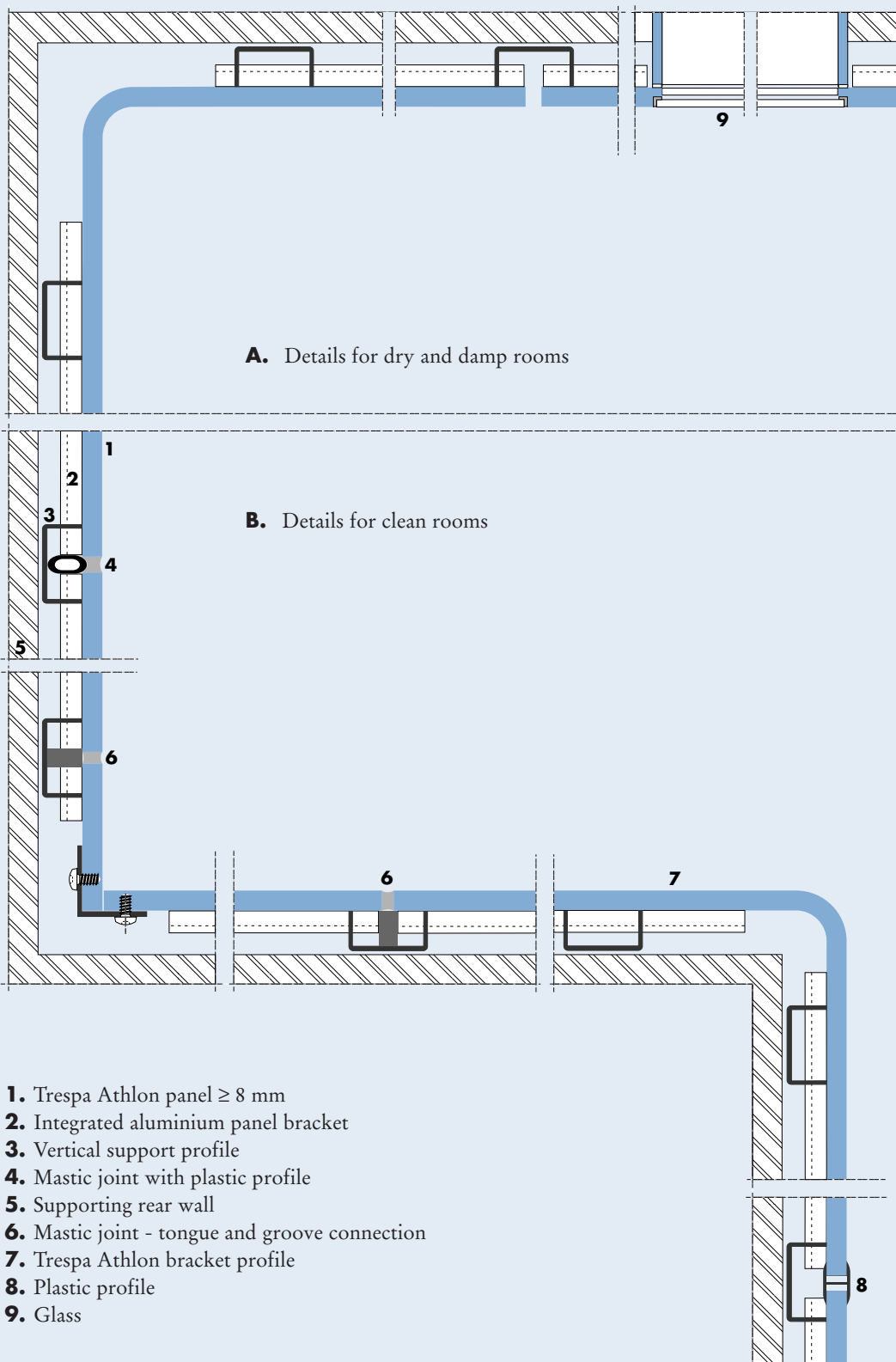

1. Trespa Athlon panel ≥ 8 mm
2. Integrated aluminium panel bracket
3. Vertical support profile
4. Mastic joint with plastic profile
5. Supporting rear wall
6. Mastic joint - tongue and groove connection
7. Trespa Athlon bracket profile
8. Plastic profile
9. Glass

Blind fixing with continuous integrated panel bracket.

Vertical cross-section

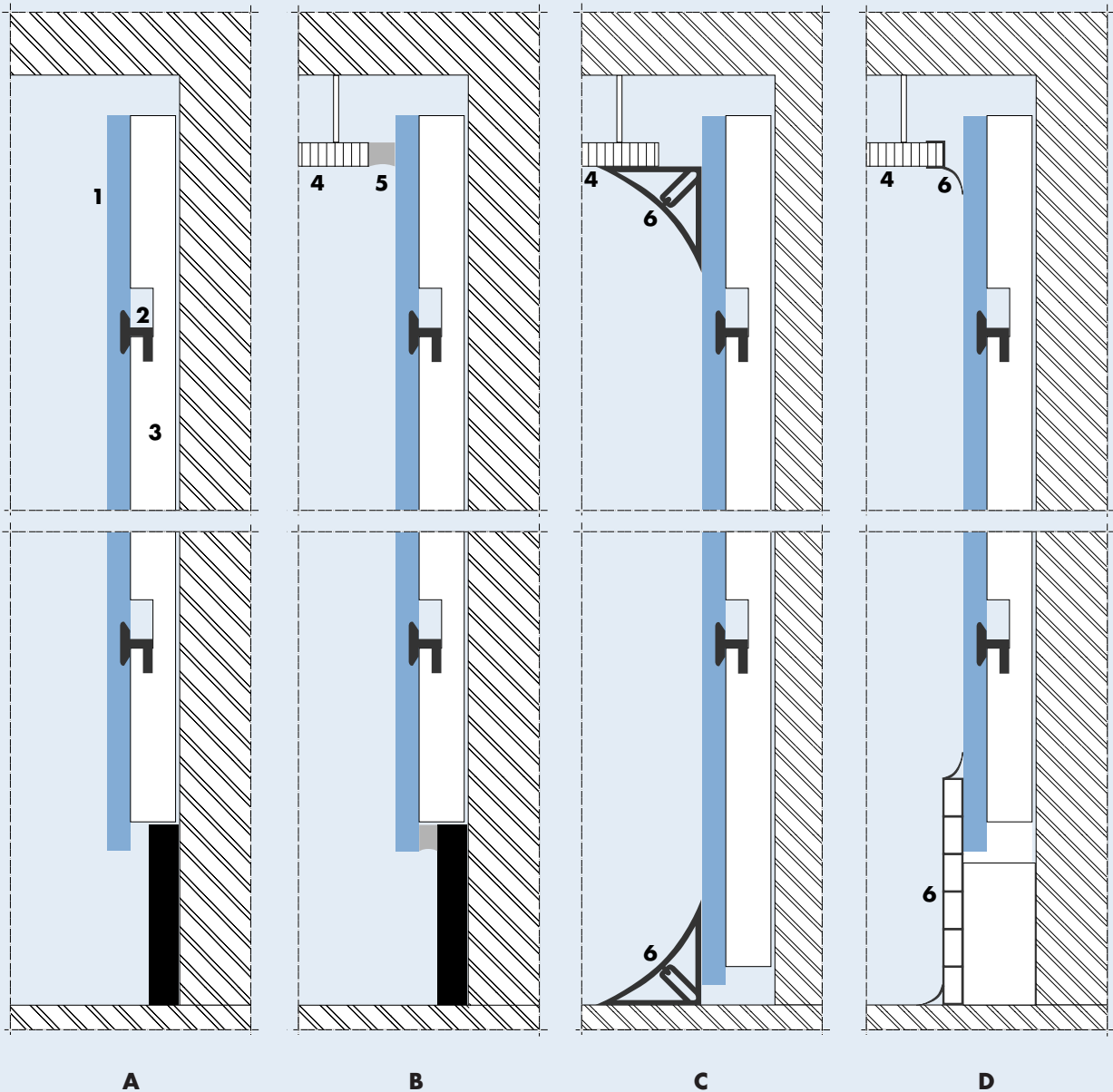

A. Details for dry and damp rooms

B. Details for operating theatres

C+D. Details for clean rooms

1. Trespa Athlon panel $\geq 8\text{mm}$

2. Integrated panel bracket

3. Vertical support bracket

4. System ceiling

5. Mastic joint

6. Plastic profile

Blind fixing with continuous integrated panel bracket.

Vertical cross-section

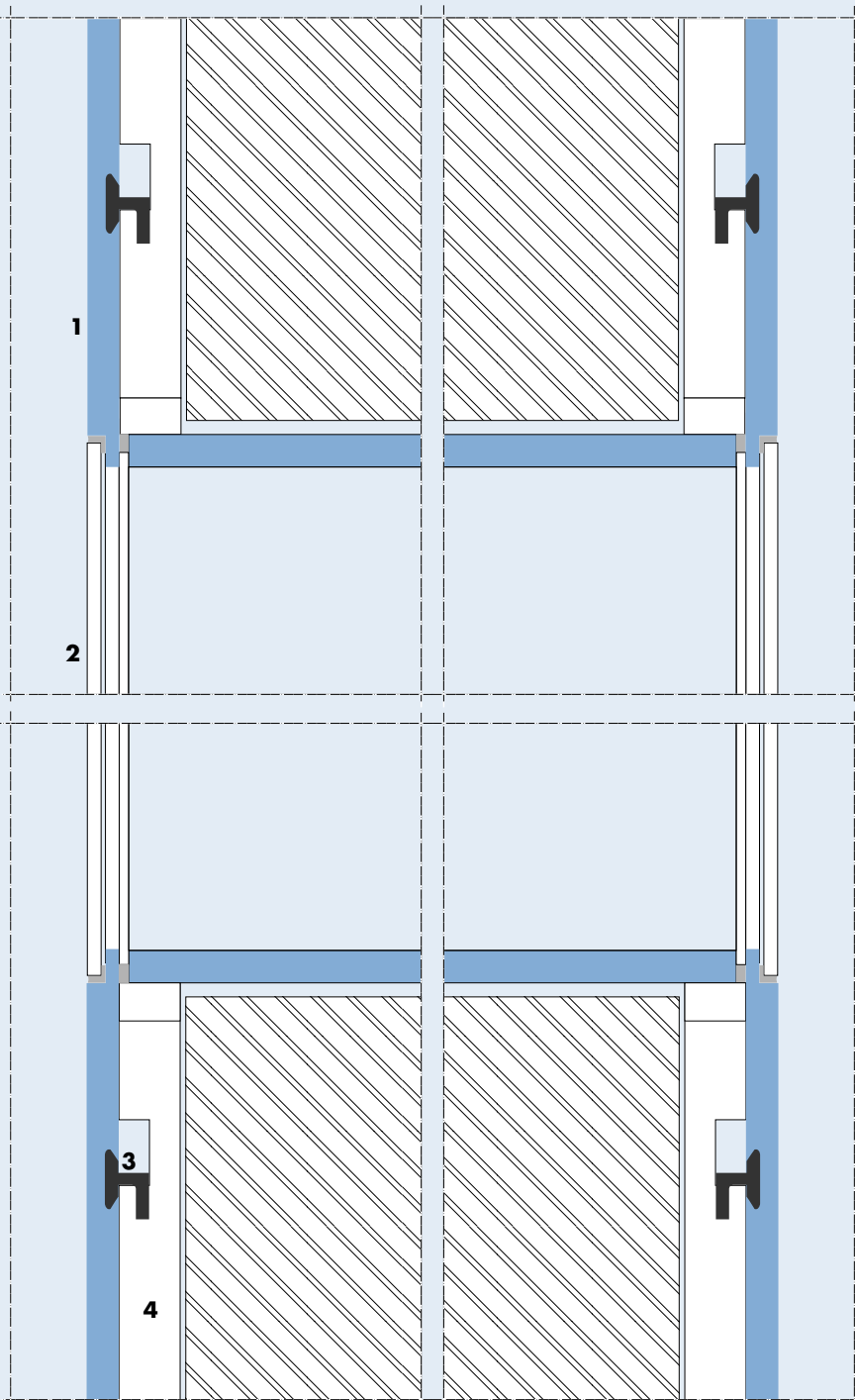

1. Trespa Athlon panel ≥ 8 mm
2. Glass
3. Integrated panel bracket
4. Vertical support profile

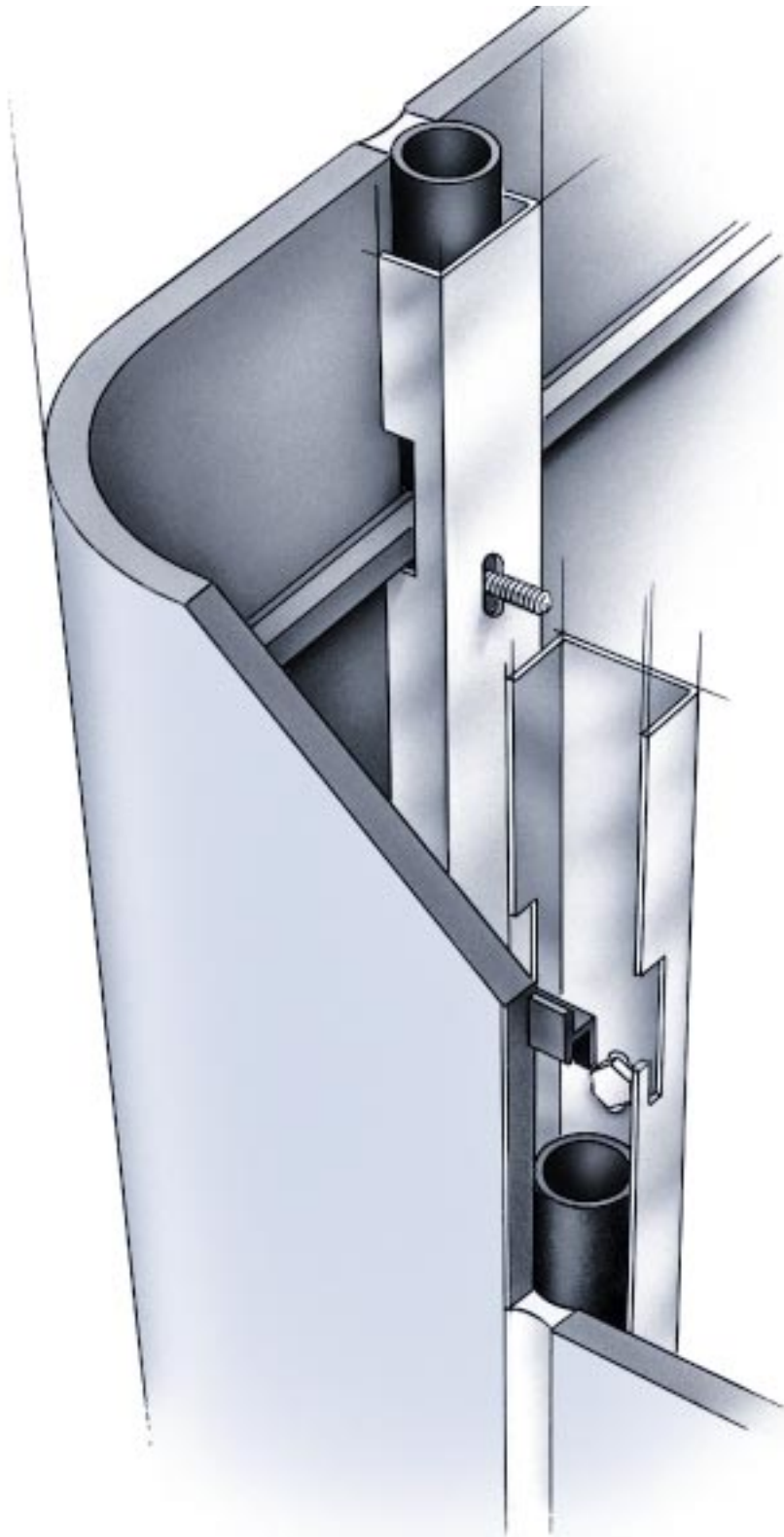

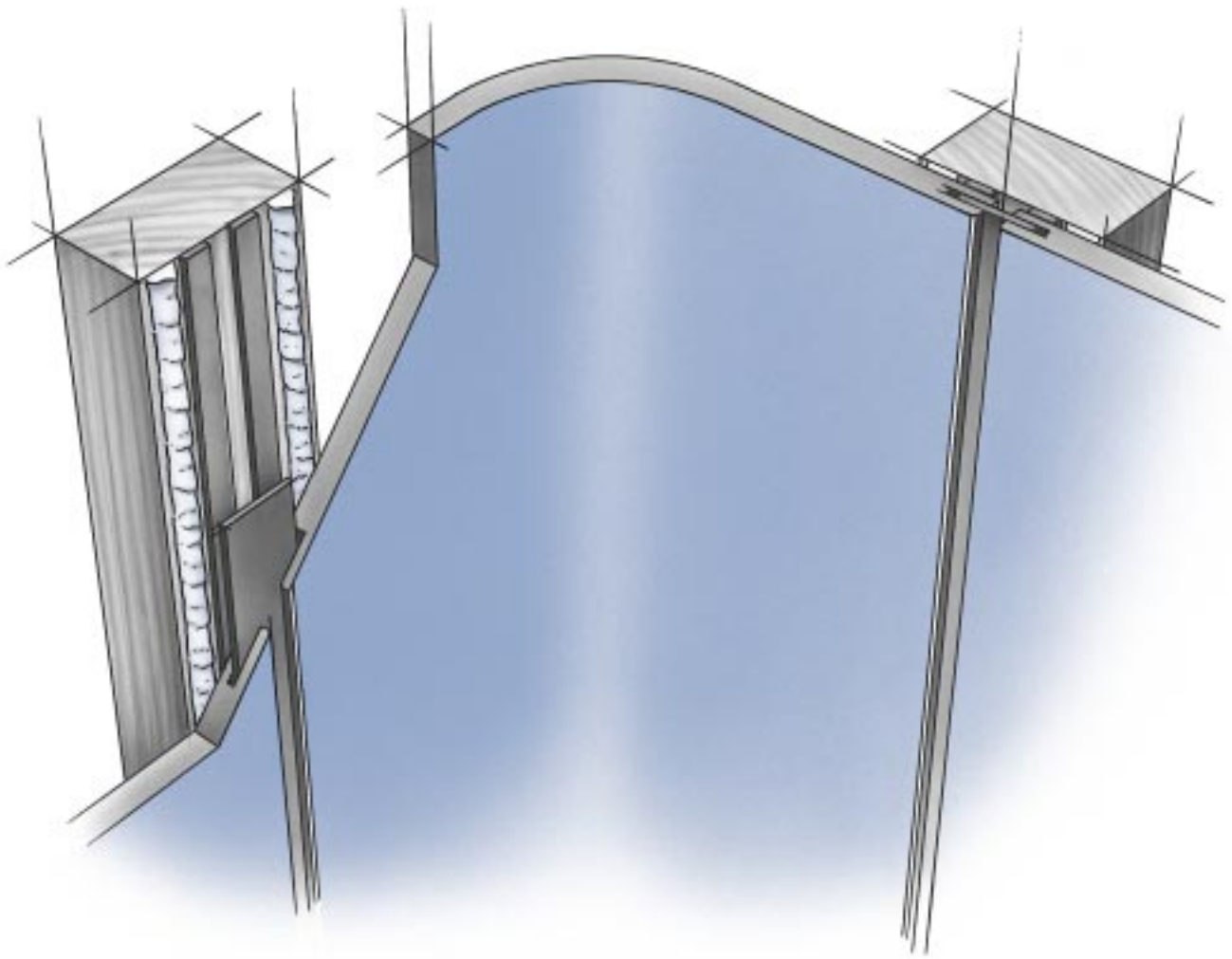

Blind fixing with adhesive.

Principal details on fixing using glue

The quality of an adhesive connection is mainly determined by the circumstances under which it was made. Damp, cold and/or dusty conditions can have a negative effect on the quality. It is possible to adhere Trespa Athlon panels to a timber or metal subframe whereby.

- the maximum permitted panel sizes should not be exceeded so that the panels can move without restriction
- the adhesive beads are applied in a vertical direction
- the instructions for the Trespa-recommended adhesive systems must be followed.

General remarks

Joints at most 8 mm
 Panel thickness from 6 mm upwards
 Panel size:
 max length 2550 mm

Fixing and edge distances

a = horizontal fixing distance (see table)
 b = panel width
 y = panel height

Maximum fixing distances:

Panel thickness	2 adhesive beads per panel	more than 2 adhesive beads per panel
6 mm	450 mm	550 mm
8 mm	600 mm	650 mm
10mm	650 mm	650 mm

Timber vertical battens, always planed, minimum sizes:

- end battens: 45 x 28 mm
- centre battens: 55 x 28 mm
- centre battens next to joint: 85 x 28 mm

Metal strips, minimum sizes:

- end strip: 45 x 2 mm
- centre strip: 55 x 2 mm
- centre strip next to joint: 85 x 2 mm

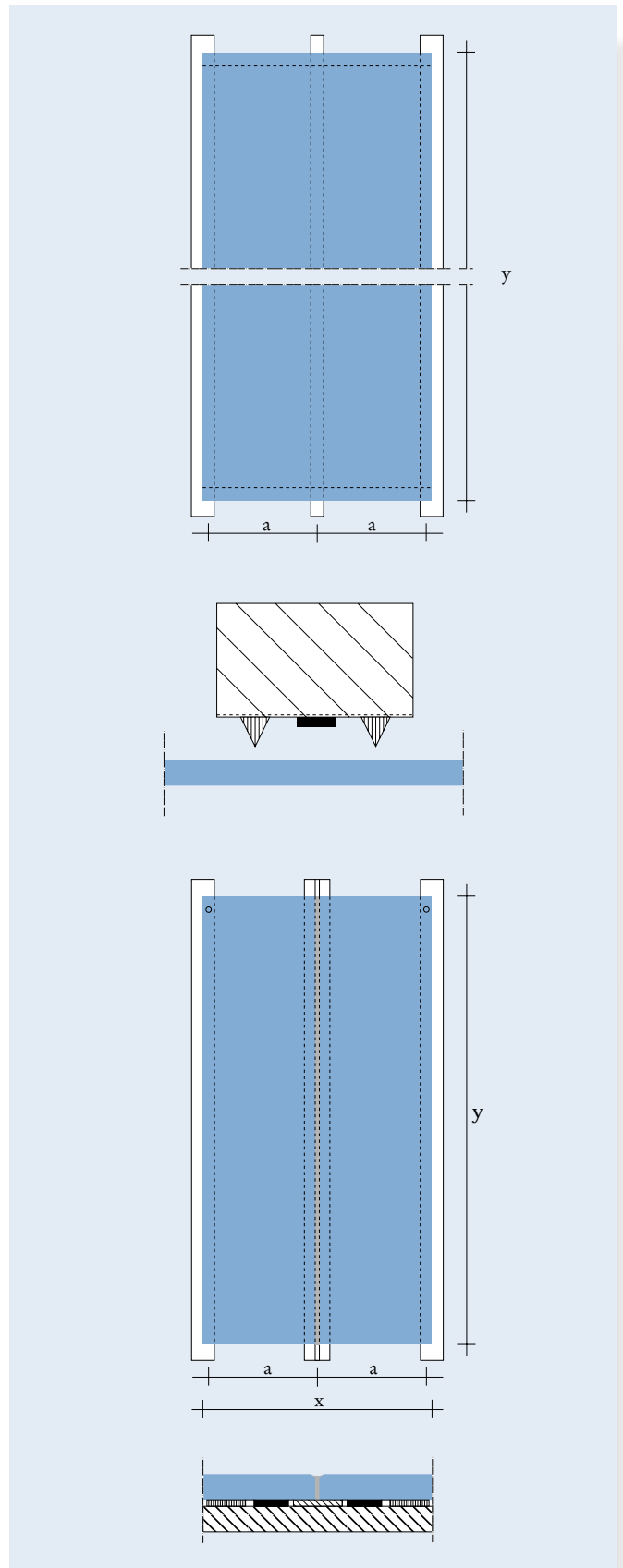

Blind fixing with adhesive.

Horizontal cross-section

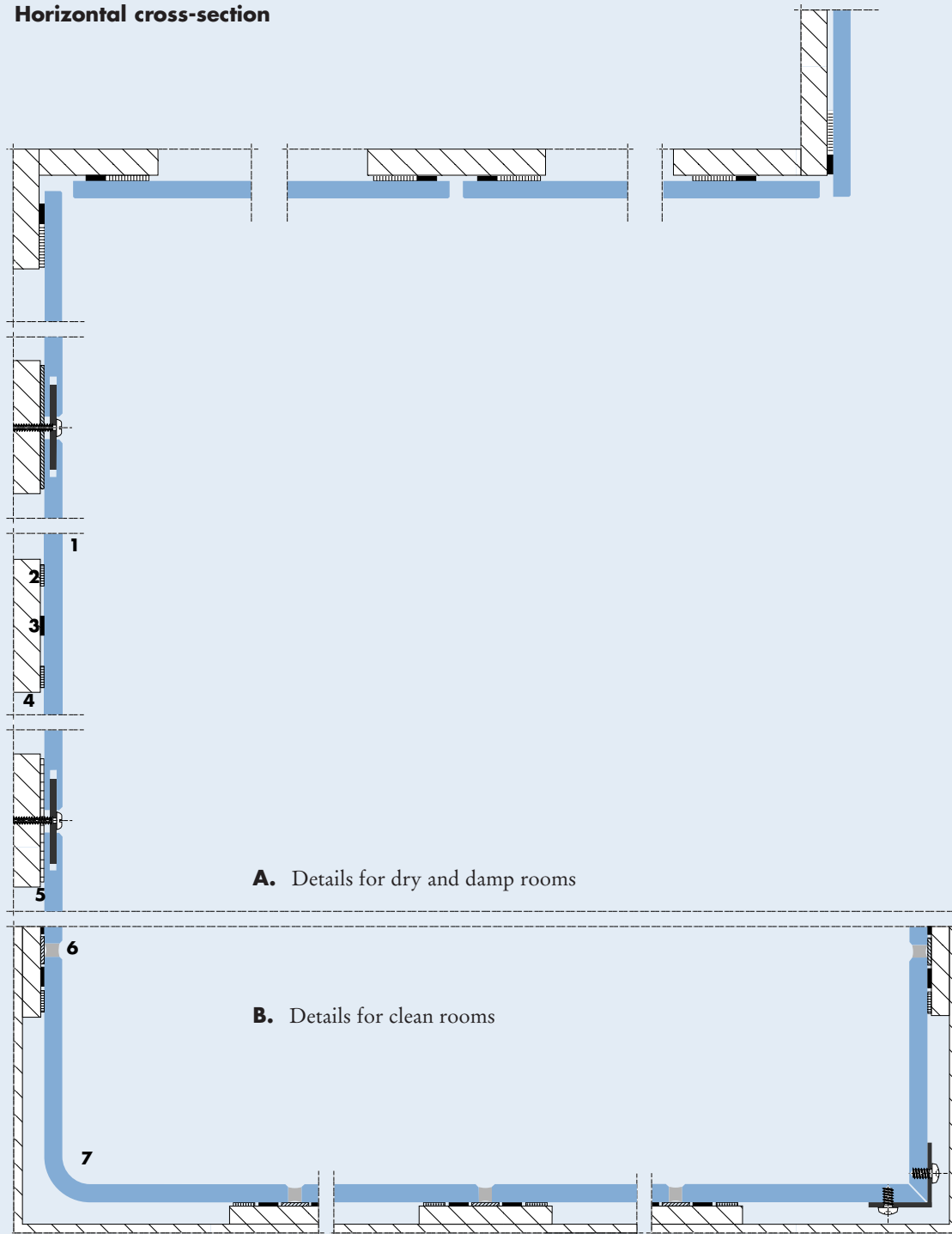

1. Trespa Athlon
2. Elastic adhesive
3. Tape 3 mm
4. Vertical lath

5. Filling
6. Mastic
7. Trespa Athlon corner profile

Blind fixing with adhesive.

Vertical cross-section

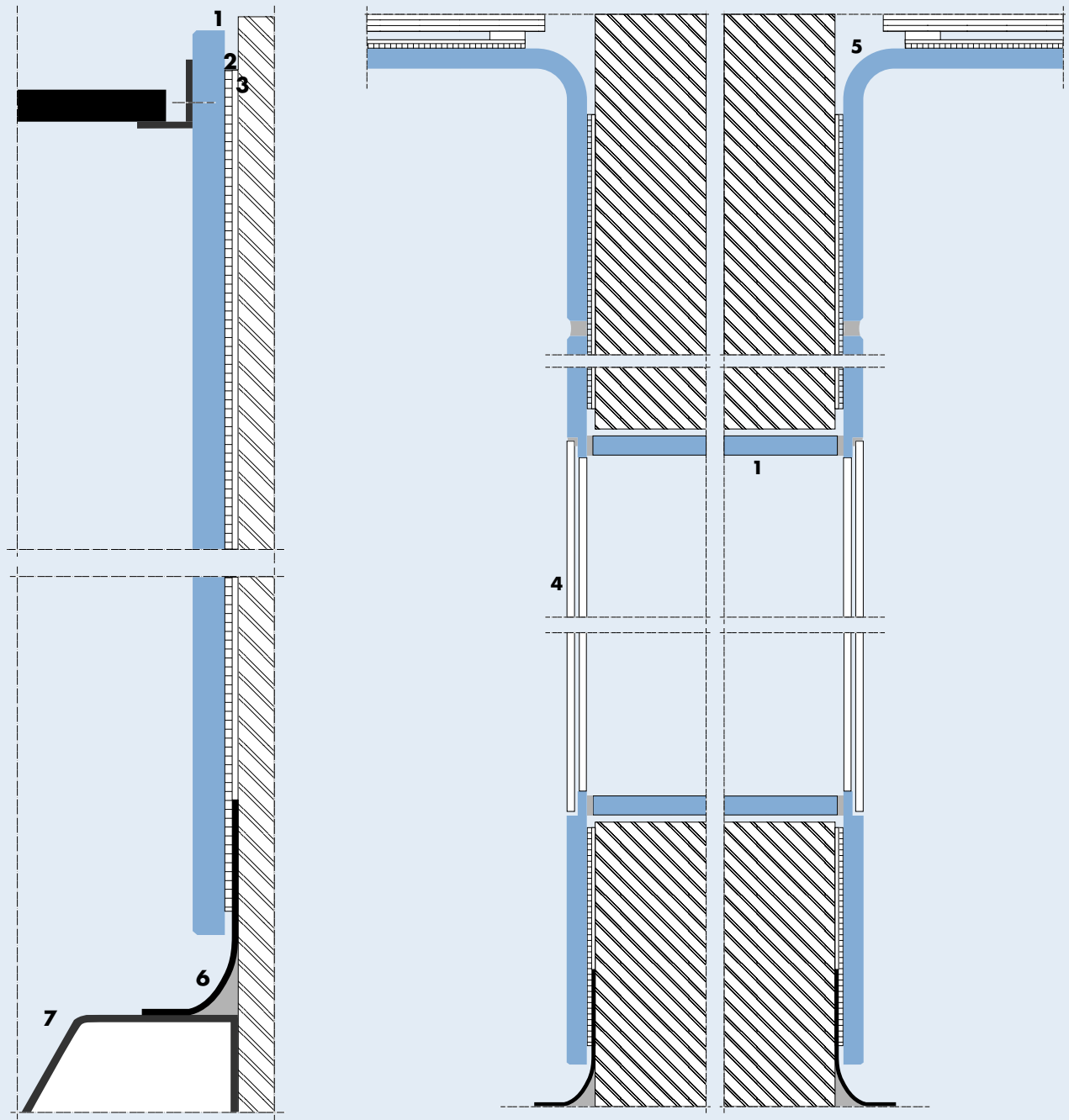

- 1. Trespa Athlon
- 2. Glue
- 3. Vertical aluminium profile 3 mm

- 4. Glass
- 5. Suspension system for ceiling
- 6. Plastic profile
- 7. Edge of bath

Semi-blind fixing with joint profile or metal tongues.

Installation

Trespa Athlon, from a panel thickness of 8 mm upwards, can be fixed semi-blind with the help of an aluminium joint profile in combination with a profile on which the panel is placed and supported. The panel is fixed by screwing the joint profile onto the subframe. From a panel thickness of 13 mm, the joint profile can be covered by a Trespa Athlon tongue with a thickness of 3 mm. Other ways of sealing the joint profile are by using a rubber profile or a PVC profile.

General remarks

Joints: screw head diameter + 5 mm

Panel thickness from 8 mm

Fixing and edge distances

a = panel span (see table)

c = vertical fixing distance in tongue: maximum 500 mm

Maximum panel span (in mm)	Panel thickness (in mm)		
	8	10	13
Panel span	600	750	950

Fixing details

Groove: at least 2.2 x 15 mm, remaining panel edge thickness in each case 2.9 mm

Metal tongue: 2 x 30 mm x panel length.

Timber batten: minimum 35 x 90 mm

Screws should be centered and not overtightened in order to avoid restricting the movement of the panel.

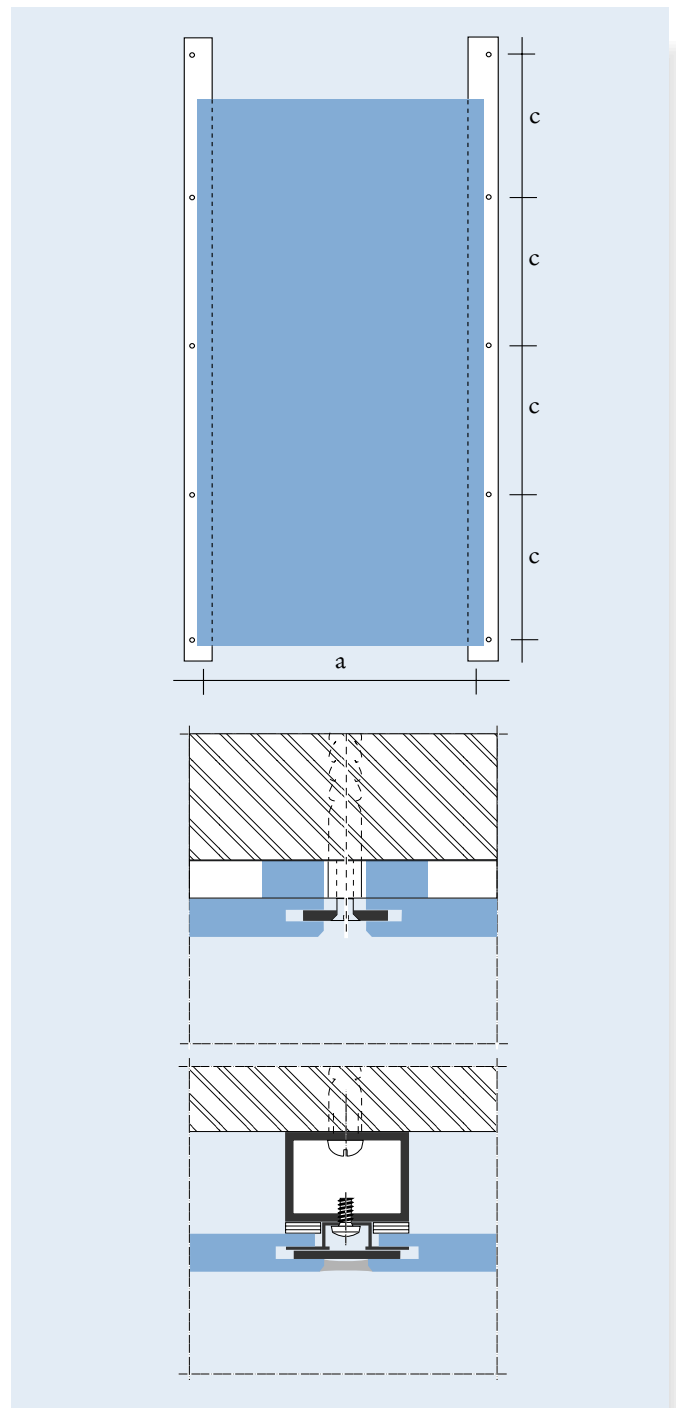

Semi-blind fixing with joint profile or metal tongues.

Horizontal cross-section

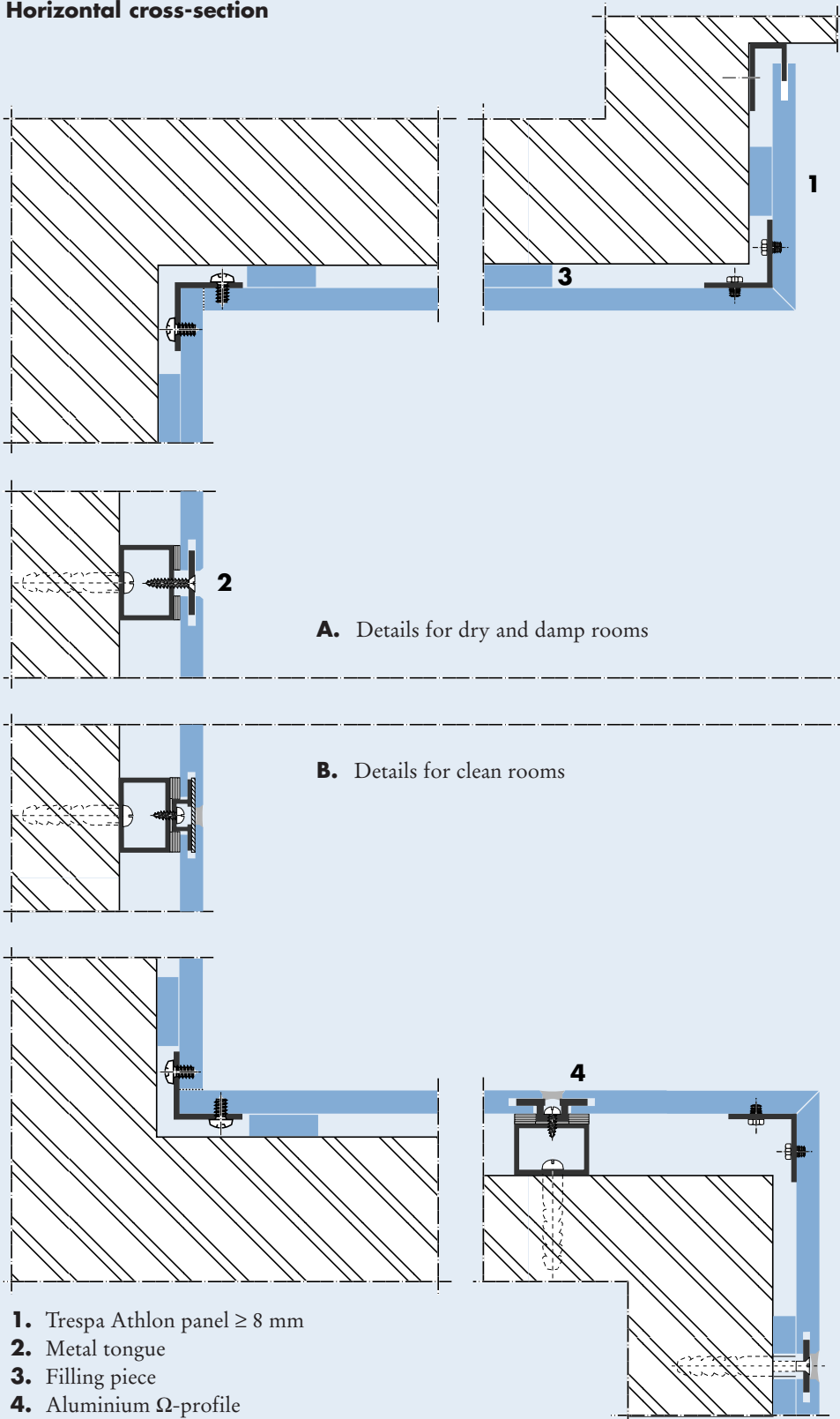

1. Trespa Athlon panel ≥ 8 mm
2. Metal tongue
3. Filling piece
4. Aluminium Ω -profile

Semi-blind fixing with joint profile or metal tongues.

Vertical cross-section

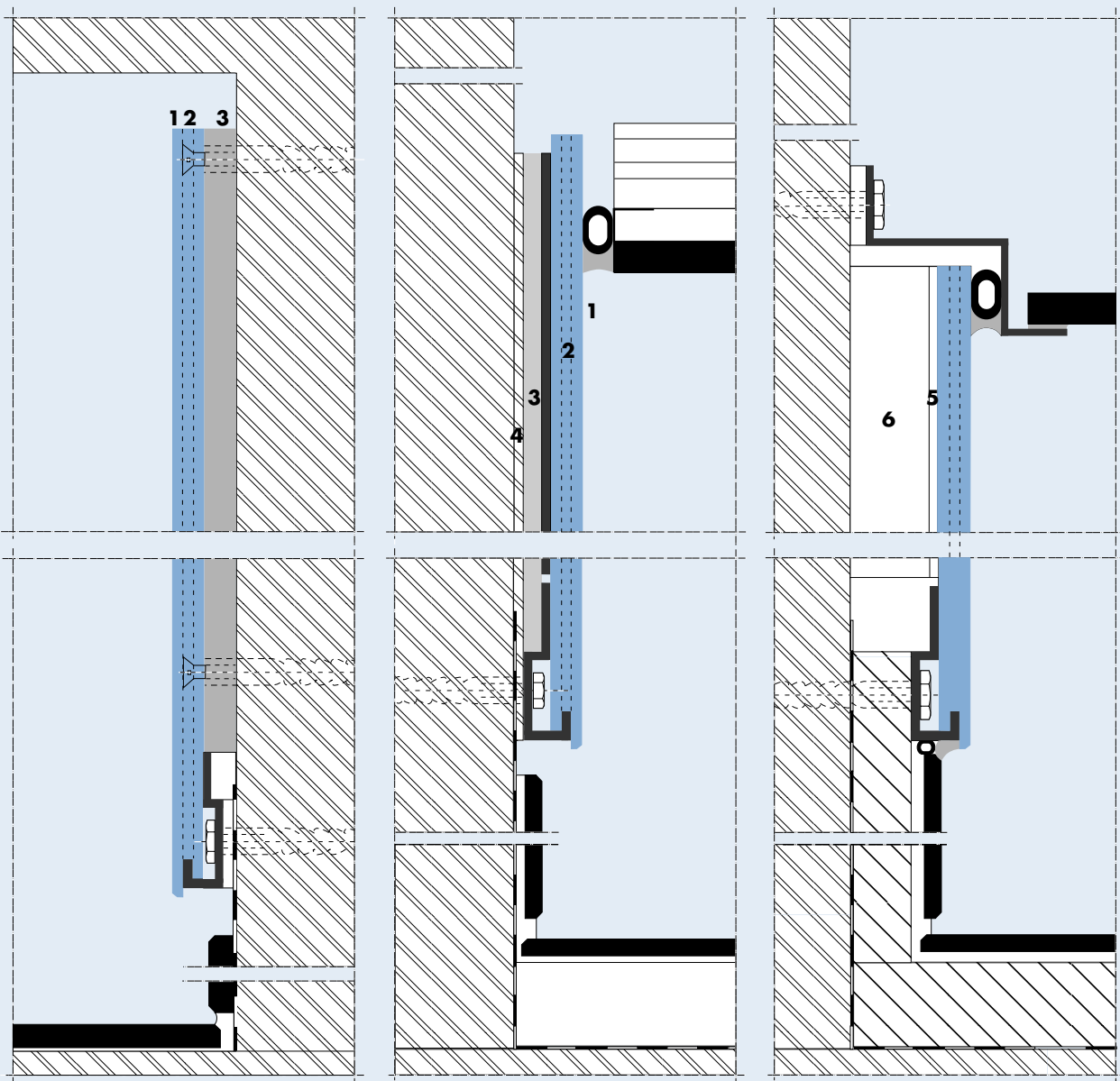

1. Trespa Athlon panel ≥ 8 mm
2. Metal tongue
3. Filling piece

4. U profile
5. Ω -profile
6. \square -profile

Applications.

Bathrooms/sanitary units

Trespa Athlon is well suited to newly built and refurbished bathrooms and sanitary units. The easy processing and fixing of the panels mean that there is wide scope for different designs, uses and applications. Due to the high rigidity and impact resistance of the panel material, it is possible to work with relatively small wall thicknesses of 10 to 16 mm. Height of doors must be cut from length and not from width of panel. Doors must be hung with a min. of 3 hinges.

From a panel thickness of 8 mm upwards, Trespa Athlon can be fixed invisibly to achieve a completely smooth finish for an aesthetically pleasing wall cladding.

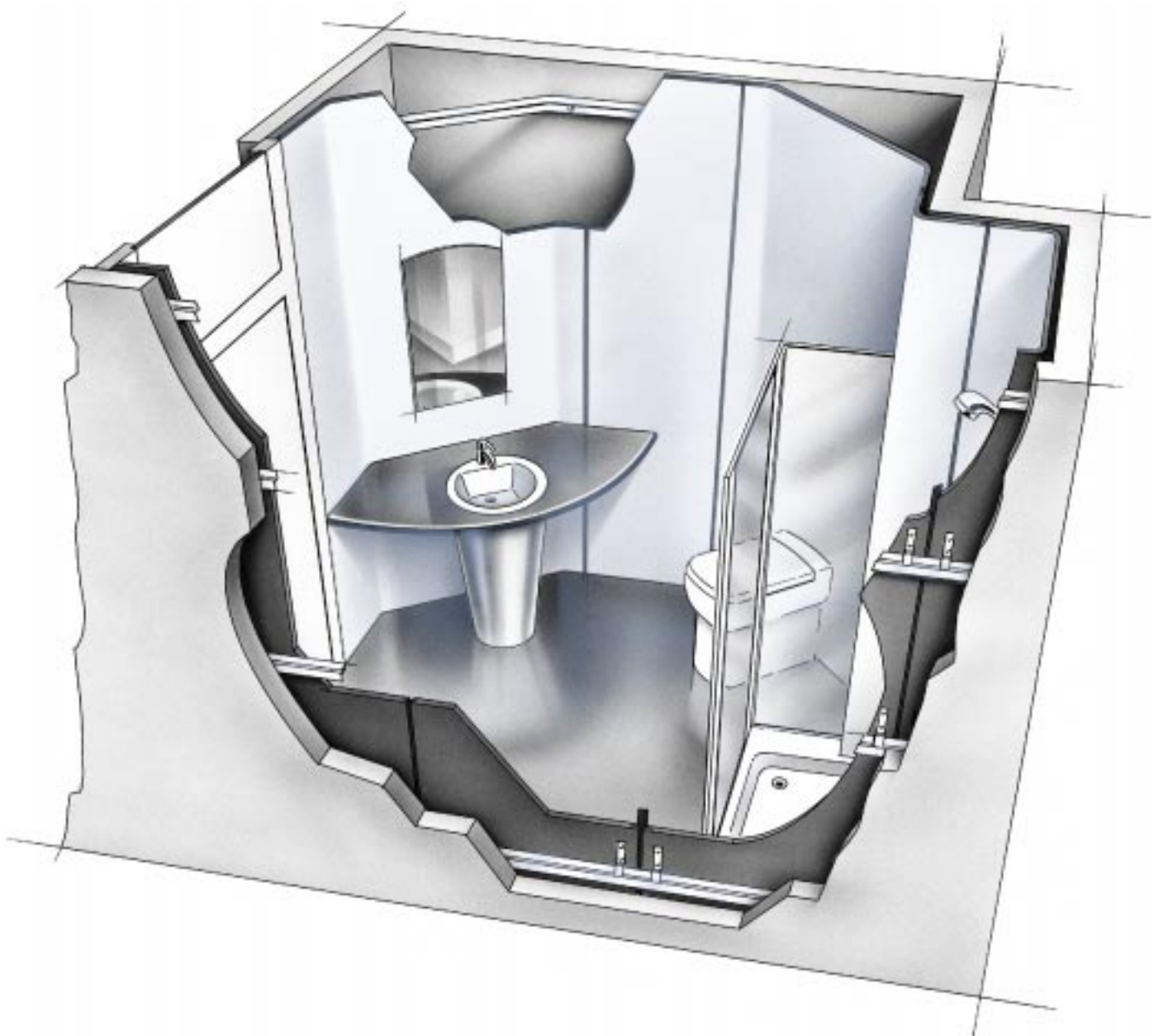

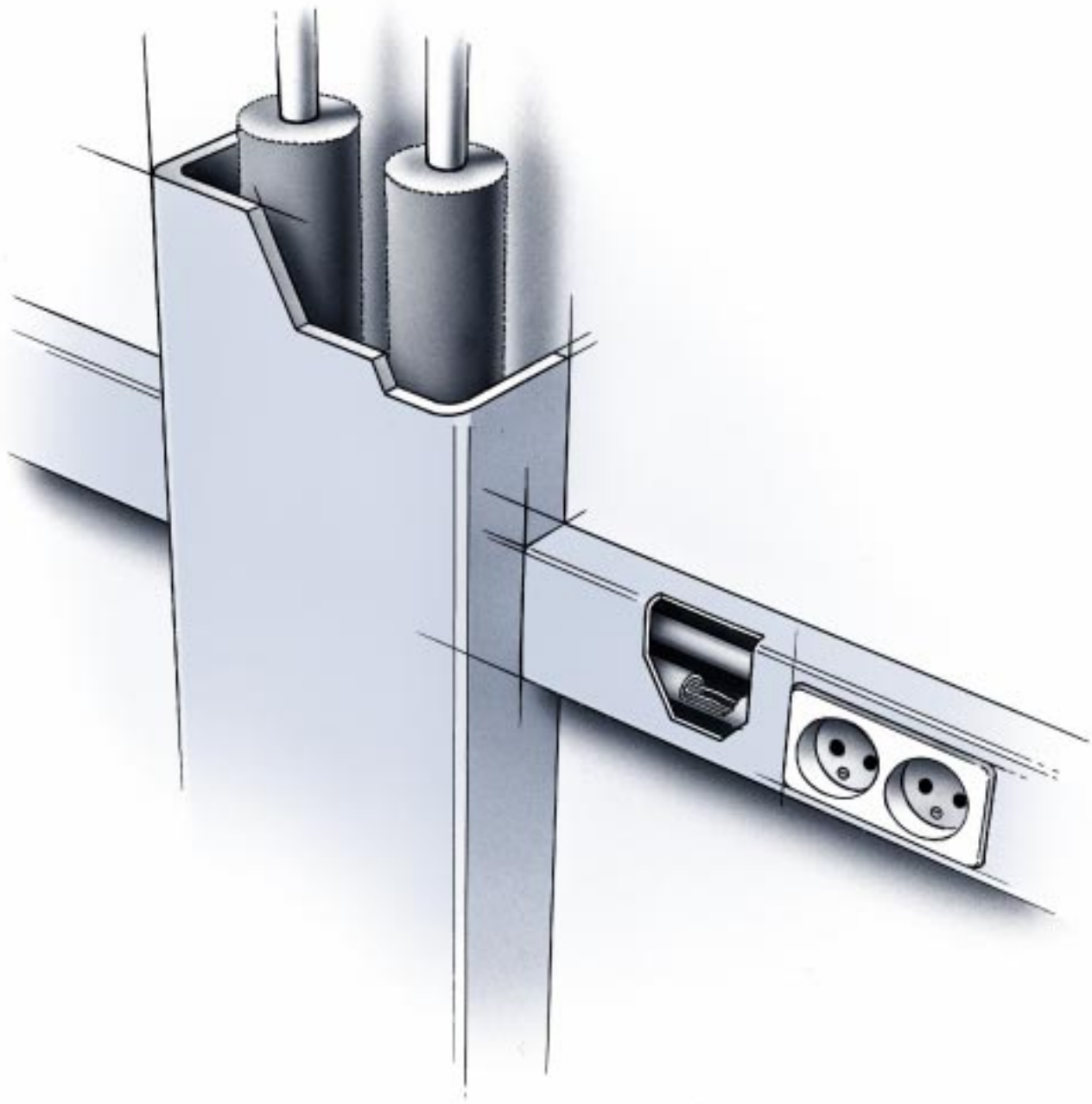

Bumper rails.

General

Bumper rails and panelling usually consist of narrow strips of wall cladding. The fixing of these and the guidelines that apply to this are no different from those described above for wall cladding.

Ventilation

The ideal situation is to leave open a space at the bottom, between the board and the wall. If this is not possible, we recommend waiting (for approximately a month) before sealing the upper and lower edge of the bumper rail. This is absolutely necessary if fixing is done onto a new structure; this has to dry first. After this period, the upper and lower edge can be sealed with a plastic profile or with mastic.

Corner solutions

Corner solutions can be implemented with post-forming elements, corner profiles or prefabricated elements.

Joints

The solutions for joints can be implemented as shown in detailed diagrams A, B, C and D.

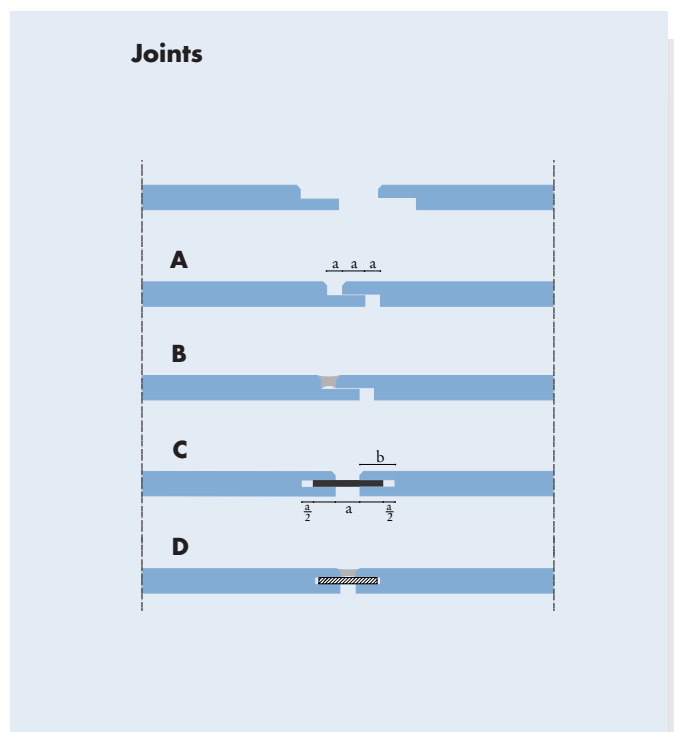
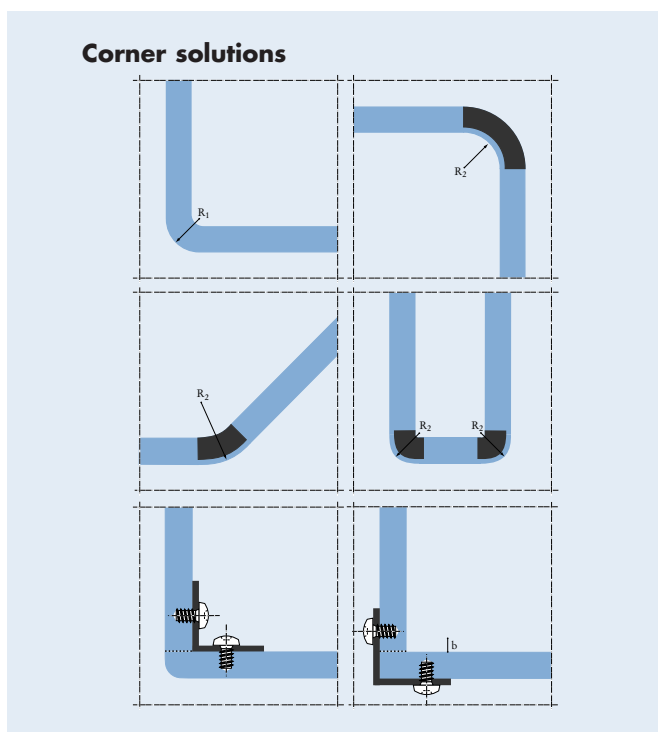
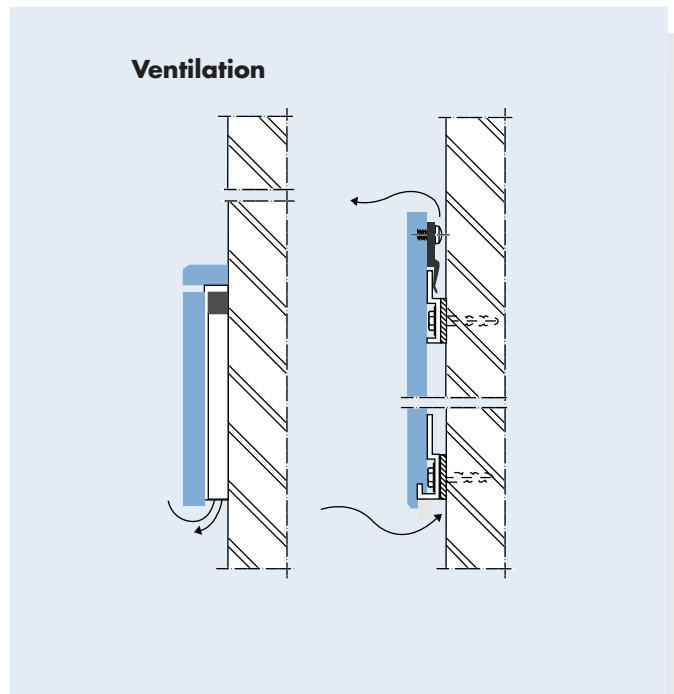

Bumper rails combined with Trespa Athlon round-cornered element.

1. Trespa Athlon ≥ 8 mm
2. Supporting plate
3. Horizontal support profile
4. Rubber profile
5. Trespa Athlon round-cornered element

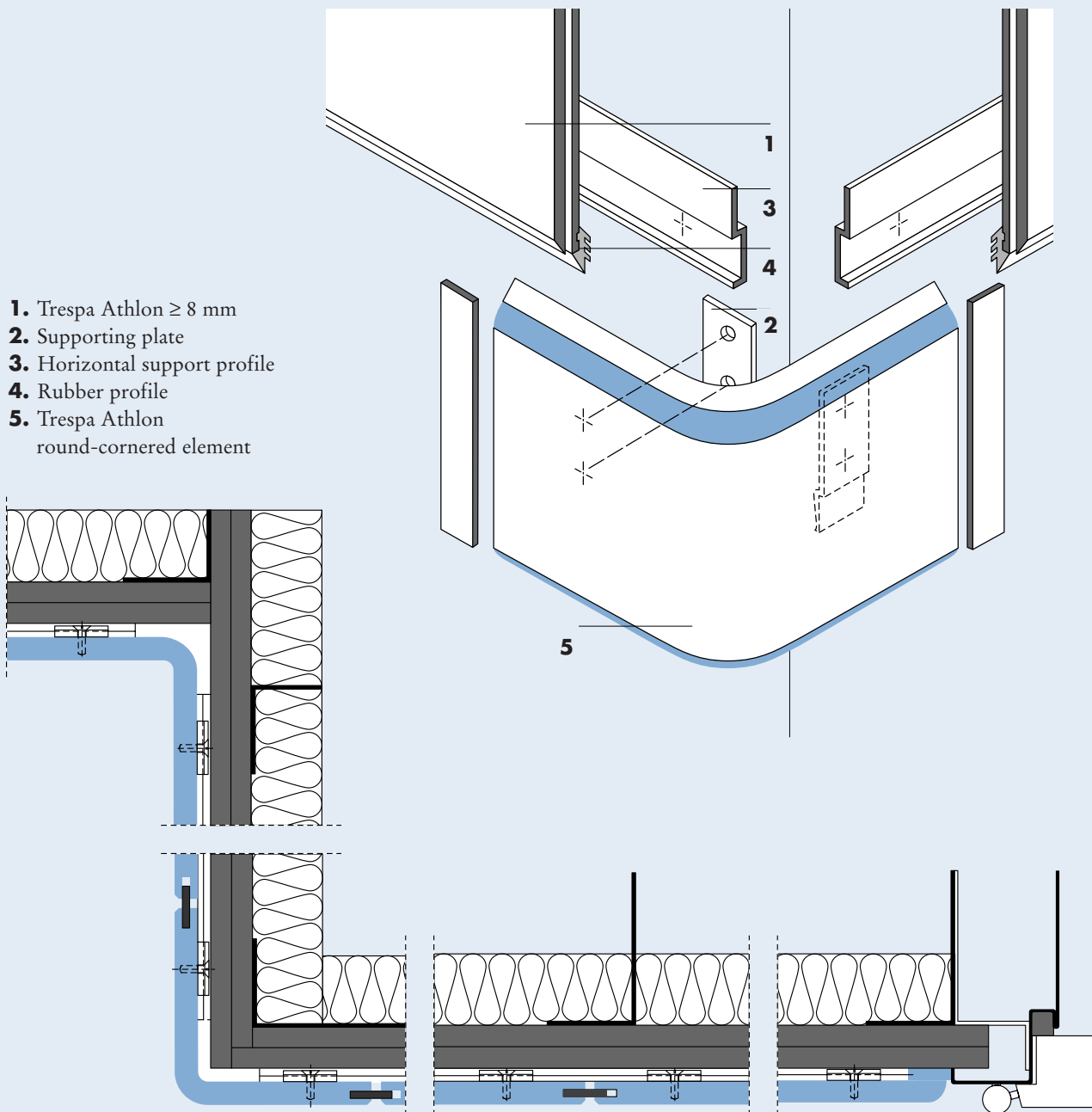

**Trespa Athlon bumper rails
combined with banister.**

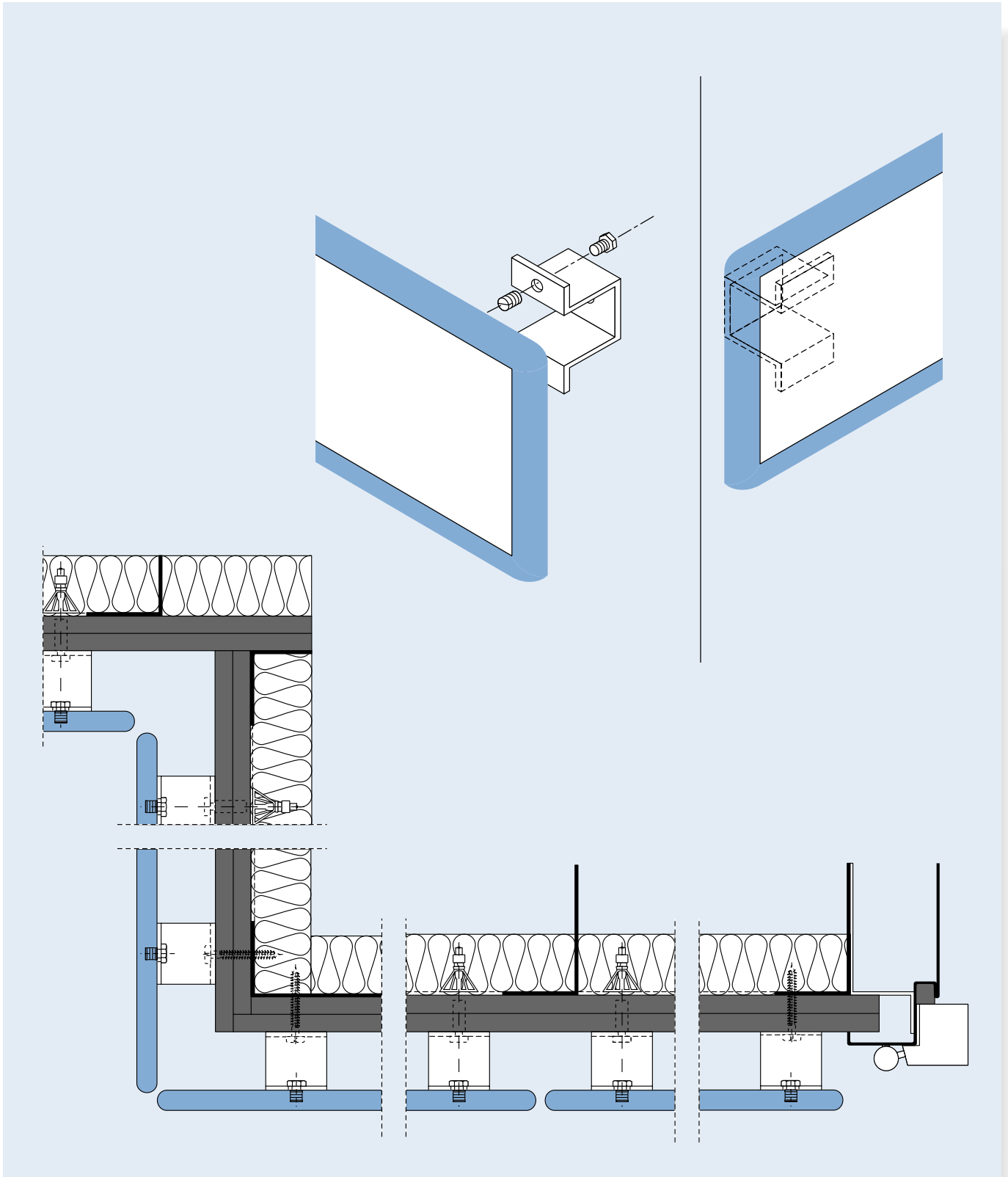

Fixing methods.

Visible fixing

1. Stainless steel quick assembly screw for Trespa for a panel thickness of 6 mm to 10 mm

- Material: stainless steel A2-1702 or stainless steel A4
- Diameter: 4.8 mm
- Length: at least 36 mm
- Head diameter: 12 mm
- Head height: 2.5 mm
- Hole diameter: 8 mm
- In all Trespa Meteor colours

If other screws are used, a minimum diameter of 4 mm and a length of 35 mm are required.

2. Skiffy Cap for Trespa from 8 mm upwards

- Material: nylon
- Colour: various colours for combination with Trespa colours
- Diameter: 12 mm (inner diameter 10 mm)
- Height: 5 mm

Quick assembly screw for Trespa

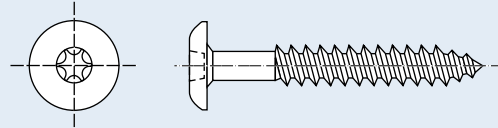

Skiffy Cap

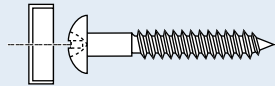

Fixing methods.

Blind fixing:

1. Fischer PA 4 M6 insert for a panel thickness of 8 mm and upwards
 - Material:
 - insert: brass
 - screw: stainless steel AZ-1702 or stainless steel A4
 - Diameter:
 - insert: 8 mm
 - screw: M6
 - Length:
 - panel thickness 8: 5.5 mm
 - panel thickness 10: 7.5 mm
 - panel thickness 13: 10.5 mm
 - Hole diameter: 8 mm
 - Hole depth: special drill with depth stop
2. Thread cutting screw for a panel thickness of 8 mm upwards
 - Type: EJOT-PT-S60
 - Material: stainless steel AZ-17092 or stainless steel A4
 - Diameter: 6 mm
 - Hole depth: special drill with depth guide
 - Ejot screw length:

Panel thickness	Thickness		Ejot type	Screw-in-drilled		
	Bracket	Washer		depth	depth	Ø
8	3	+ 2*	S60 x 9,5 stainless steel A4	4.5	5.5	5.3
8	5	+ 0	S60 x 9,5	4.5	5.5	5.3
10	3	+ 0	S60 x 9,5	6.5	7.5	5.3
10	5	+ 0	S60 x 11,5	6.5	7.5	5.3
13	3	+ 0	S60 x 11,5	8.5	9.5**	5.3
13	5	+ 0	S60 x 14,5	9.5	10.5	5.3

* 2 mm washer

** no standard special drill available

3. Stainless steel tension free insert for panel thickness of 8 mm upwards
 - Type: Keil Hinterschnittdübel M6
 - Material: stainless steel A4
 - Hole depth.
 - panel thickness 8: 5 mm
 - panel thickness 10: 7 mm
 - panel thickness 13: 10 mm
 - Hole diameter: 7 mm / 9 mm
 - To be fitted with a special drill which is supplied with this type of anchoring device.

Insert

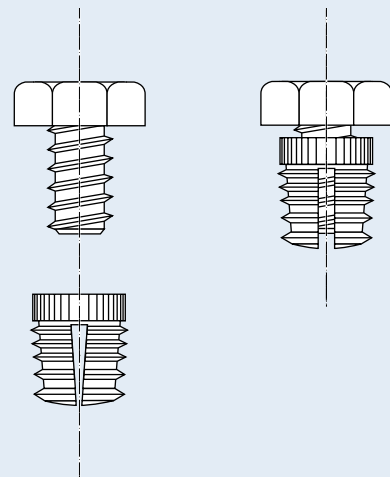

Thread cutting screw

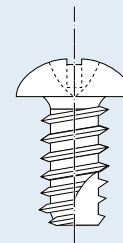

Tension free insert

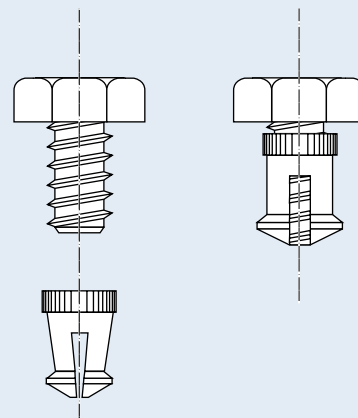

Notes.

Quality.

Trespa International BV

Trespa International BV specializes in high quality panel material for façade cladding and interior use. Trespa has both the expertise and the means to develop products for specific segments of the market. Trespa is continually looking for ways to protect the environment even more effectively.

Three perfect product lines

Production of the façade cladding material Trespa Meteoron is based on unique, patented techniques, which guarantee excellent weather resistance and colourfastness. Trespa Athlon, which offers you outstanding moisture resistance along with scratch and wear resistance, is particularly suitable for interior use. And Trespa TopLab ^{PLUS}, highly resistant to chemicals and designed for use as laboratory worktops, completes the product programme. With the products and services of the Inspirations line, Trespa meets specific wishes in state of the art architectural applications.

ISO 9001



Trespa guarantees quality of both products and services. We offer our customers optimal technical support as well as straightforward documentation. Proof of this approach is the award of the ISO 9001 certificate.

Whatever your requirements, Trespa offers a full support service. Please contact us for further information.

Typically Trespa.

Trespa UK Ltd

Grosvenor House
Hollinswood Road
Central Park, Telford
TF2 9TW
Tel.: 44 (0) 1952 290707
Fax: 44 (0) 1952 290101
Info@trespa.co.uk

Trespa International BV

Postbus 110, 6000 AC Weert
Wetering 20, 6002 SM Weert
The Netherlands

Verkoop Nederland

Tel.: 31 (0) 495 458 850
Fax: 31 (0) 495 540 535
infonederland@trespa.com

Export Department Europe/Middle East Asia/Pacific

Tel.: 31 (0) 495 458 359 / 392 / 578
Fax: 31 (0) 495 458 383
infoexport@trespa.com

Trespa Deutschland GmbH

Richmodstrasse 6
50667 Köln
Telefon: 0800 - 186 04 22
Telefax: 0800 - 186 07 33
infodeutschland@trespa.com

Trespa Belgium Bvba/Sprl

H. van Veldekesingel 150 B. 19
3500 Hasselt
Tel.: 0800 - 15501
Fax: 0800 - 15503
infobelgium@trespa.com

Trespa France

18 rue Chartran
92200 Neuilly sur Seine
Tel.: 33 (0) 1 41 92 04 80
Fax: 33 (0) 1 41 92 04 89
infofrance@trespa.com

Trespa North America Ltd.

12267 Crosthwaite Circle
Poway, CA 92064
Tel.: (1)-800-4-TRESPA
Fax: (1)-858-679-0440
e-mail:
sales@trespanorthamerica.com

Trespa Japan Ltd.

Toranomon Toyo Building 6F
4-2 Toranomon, 1-chome
Minato-ku, Tokyo 105
Tel.: 81 (0) 3 3500 5080
Fax: 81 (0) 3 3504 0034

www.trespa.com

Registered trademarks

© Trespa, Meteoron, Athlon, Toplab, Volkern, Ioniq and Inspirations are registered trademarks of Trespa International BV.

Responsibility

All information is based on our current state of knowledge. It is intended as information concerning our products and their application possibilities, and is therefore not intended as any form of guarantee with regard to any specific product characteristic.

Colours

The colours in this document are printed, and therefore, may vary slightly from the original Trespa panel colours with respect to gloss, colour shades and surface texture. Original samples are available on request.

Copyrights

© All rights reserved. No part of this publication may be reproduced, stored in a retrieval system, or made public, in any form or by any means, either graphic, electronic or mechanical, including photocopying, recording or otherwise, without the prior written permission of Trespa International BV.

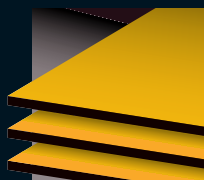

TRESPA

All the best qualities in one panel

