

**The interior wall system**

**...à la carte.**



**All the best qualities in one panel**

A blurred woman in a white dress is walking on a staircase. The entire scene is bathed in a strong blue light, creating a monochromatic aesthetic. The background consists of large, rectangular panels, possibly glass or stone, with dark lines separating them. The woman's motion is captured with a long exposure, resulting in a soft, out-of-focus appearance. The floor is also tiled with large, light-colored tiles.

# **TS2000, as practical as it is stylish**

*An excellent combination of aesthetics, functionality and durability*

# The best of Trespa wall panels can now be applied quite simply in your interior environment

**Attractive** The attractive and functional properties of Trespa Athlon and Trespa Virtuon can now be combined with the practical and invisible mounting method of system TS2000. This innovative wall system utilises the imaginative decorative effects, colours and structures that are available in economic panel dimensions for a variety of applications.

**Low costs** The fast and easy to use TS2000 wall system is very cost efficient, resulting in overall savings when compared with traditional wet trade methods. Modern construction techniques demand speed of installation and minimal site labour cost.

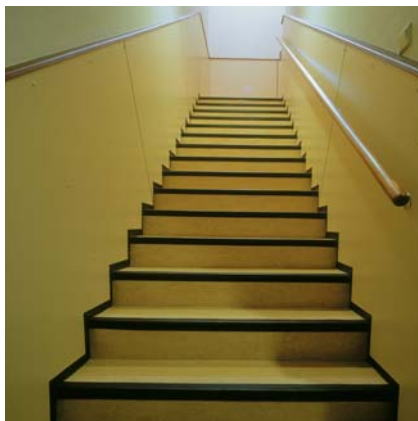

**Trespa clip**



**Trespa clip fixed on metal framework**

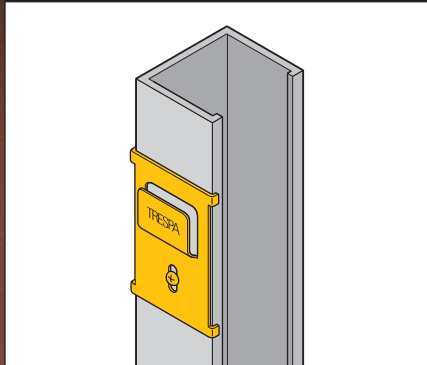

**Z-profile fixed on Trespa panel**

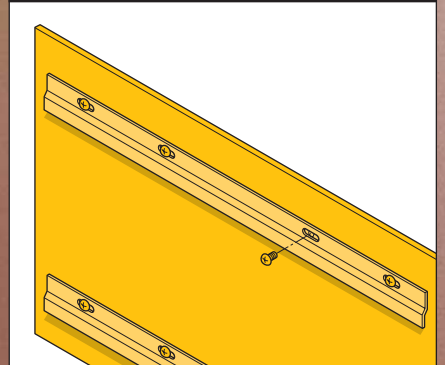

**Trespa panel with z-profile clipped onto a metal framework**

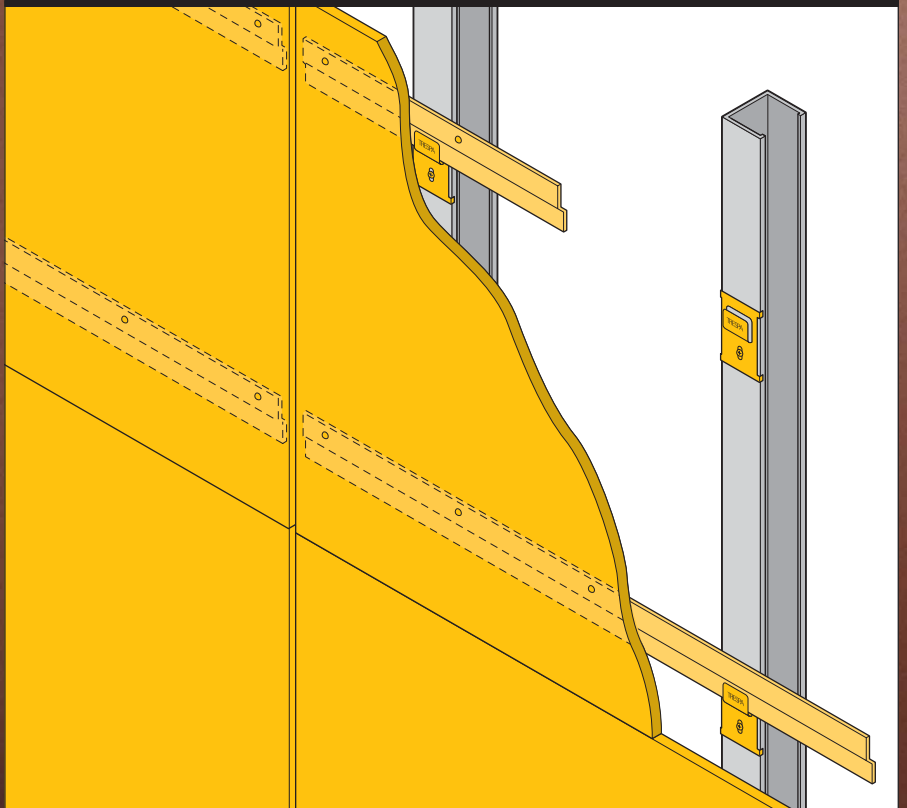

## Systematic convenience

### Immediately ready for use

Trespa's wall panels provide a simple and stylish method for constructing durable interior walls. The combination of the horizontal z-profiles fixed to the panel and the patented clip offer an effective solution for installing panels on an upright metal framework. The combination of TS2000 and Trespa interior wall panels provide you with an effective wall that is ready for use immediately after mounting.

### Certified Fire Resistant, Hygienic and soundproof

The z-profiles, which fit into the patented metal clips, can be easily mounted on the panels. The clips can be used on upright metal frameworks. As a result, not only can the wall panels be mounted quickly, they can also be easily and quickly disassembled. The Trespa wall system conforms to stringent fire regulations, is resistant to graffiti, soundproof and is very hygienic and easy to clean, basically all the qualities required for demanding applications in public, commercial and industrial buildings, healthcare and nursing sector, schools, universities, laboratories, clean rooms, offices, stations and airports. In areas requiring low maintenance and where cleaning needs are a crucial cost factor can also benefit from TS2000.

Data	Type	Frame width mm	Panel thickness mm	Cavity mm insulation mm	Fire resistance NEN6069: 1997 NEN-EN 1364-1	Sound insulation EN ISO 140-3:1995
01		75 mm	2 x 10 mm	88 mm no insulation	-	43dB laboratory
02		75 mm	2 x 10 mm	88 mm mineral wool 75 mm	30 minutes	57dB laboratory
03		2 x 75 mm	2 x 10 mm + 6 mm	153 mm mineral wool 2 x 75 mm	30 minutes	64dB laboratory
04	wall cladding*	Clip 4,7 mm or 4,9 mm	1 x 10 mm	12 mm no insulation	-	-
05	wall cladding	75 mm	1 x 10 mm	87 mm mineral wool 75 mm	-	-

\* shim 6 mm

TS2000 is suitable as a lightweight partition wall in three versions as well as a wall cladding system.

# Trespa Athlon and Trespa Virtuon, for superb finished walls.

## **Durable design**

The Trespa TS2000 wall system, with all the properties of Trespa Athlon and Trespa Virtuon is now within your reach. Both attractive ranges are available in many colours and structures, allowing you to create any interior design ambience. In addition, the Trespa wall panels are exceedingly strong and exceptionally easy to clean. Trespa Athlon and Trespa Virtuon are scratch and impact-resistant, retain their colour, resist temperature fluctuations and are very easy to maintain.

## **Savings on all fronts**

The special properties of Trespa Athlon and Trespa Virtuon also yield considerable cost savings. The durability, hygienic and low maintenance related aspects all contribute to the long-term savings. In addition, the various insulation values yield their own specific savings.

The end result is a system that provides both the client and designer with an integrated solution to many interior construction issues.



A blue-tinted photograph of a modern staircase. The staircase features a glass railing with a metal handrail. The steps are made of a light-colored material, possibly concrete or stone, with a textured surface. In the background, a door with a window is visible. The overall scene is clean and modern.

**The combination of aesthetics, functionality and durability opens up completely new possibilities for building interiors.**

VISIT OUR WEBSITE  
WWW.TRESPA.COM

## Quality.

### Trespa International BV

Trespa International BV specializes in high quality panel material for façade cladding and interior use. Trespa has both the expertise and the means to develop products for specific segments of the market. Trespa is continually looking for ways to protect the environment even more effectively.

### Four perfect product lines

Production of the façade cladding material Trespa Meteoron is based on unique, patented techniques, which guarantee excellent weather resistance and colourfastness. Trespa Athlon, which offers you outstanding moisture resistance along with scratch and wear resistance, is particularly suitable for interior use. Trespa Virtuon is aesthetically pleasing and the perfect product for interior applications where durability, hygiene, cleanability are required. And Trespa TopLab<sup>PLUS</sup>, highly resistant to chemicals and designed for use as laboratory worktops, completes the product programme.

Trespa guarantees quality of both products and services. We offer our customers optimal technical support as well as straightforward documentation. Proof of this approach is the award of the ISO 9001 and ISO 14001 certificates.

Whatever your requirements, Trespa offers a full support service. Please contact us for further information.

To all our offers, quotations, sales, deliveries and supplies and/or agreements, and to all related services and activities the Trespa International B.V. General Conditions of Sale apply, filed at the Venlo Chamber of Commerce on 1 January 2004, registered under number 24270677, and appearing on the website at [www.trespa.com](http://www.trespa.com). The text of these General Terms and Conditions will be sent to you upon request.



### Conditions of Sale

## Design à la carte.

### Trespa UK Ltd

Grosvenor House  
Hollinswood Road  
Central Park, Telford  
TF2 9TW  
Tel.: 44 (0) 1952 290707  
Fax: 44 (0) 1952 290101  
Info@trespa.co.uk

### Trespa International BV

Postbus 110, 6000 AC Weert  
Wetering 20, 6002 SM Weert  
The Netherlands

### Verkoop Nederland

Tel.: 31 (0) 495 458 850  
Fax: 31 (0) 495 540 535  
infonederland@trespa.com

### Export Department Europe/Middle East Asia/Pacific

Tel.: 31 (0) 495 458 359 / 392 / 578  
Fax: 31 (0) 495 458 383  
infoexport@trespa.com

### Trespa Belgium Bvba/Sprl

H. van Veldekesingel 150 B. 19  
3500 Hasselt  
Tel.: 0800 - 15501  
Fax: 0800 - 15503  
infobelgium@trespa.com  
Grand Duché de Luxembourg  
Tel.: 31 (0) 495 458 308

### Trespa Germany GmbH

Richmodstraße 6, 50667 Köln  
Tel.: 0800 - 186 04 22  
Fax: 0800 - 186 07 33  
infodeutschland@trespa.com

### Trespa France

18 rue Chartran  
92200 Neuilly sur Seine  
Tel.: 33 (0) 1 41 92 04 80  
Fax: 33 (0) 1 41 92 04 89  
infofrance@trespa.com

### GET s.l.

Gran Via, 680 ático  
08010 Barcelona  
Tel.: 34 (93) 488 03 18  
Fax: 34 (93) 487 32 36  
[www.getsl.com](http://www.getsl.com)  
[consulta@getsl.com](mailto:consulta@getsl.com)

### Trespa North America Ltd.

12267 Crosthwaite Circle  
Poway, CA 92064  
Tel.: (1)-800-4-TRESPA  
Fax: (1)-858-679-0440  
info@trespanorthamerica.com

### Trespa Japan Ltd.

Toranomon Toyo Building 6F  
4-2 Toranomon, 1-chome  
Minato-ku, Tokyo 105-0001  
Tel.: 81 (0) 3 3500 5080  
Fax: 81 (0) 3 3504 0034  
webmaster@trespa.co.jp

### Trespa China Co. Ltd.

Room 2907, Plaza 66  
No. 1266 Nanjing Road (W)  
Shanghai 200040 P.R.C.  
Tel.: 86 (0) 21 6288 1299  
Fax: 86 (0) 21 6288 1296  
infochina@trespa.com.cn

### Registered trademarks

® Trespa, Meteoron, Athlon, Toplab, Virtuon, Volkern, Ioniq and Inspirations are registered trademarks of Trespa International BV.

### Responsibility

All information is based on our current state of knowledge. It is intended as information concerning our products and their application possibilities, and is therefore not intended as any form of guarantee with regard to any specific product characteristic.

### Colours

The colours in this document are printed, and therefore, may vary slightly from the original Trespa panel colours with respect to gloss, colour shades and surface texture. Original samples are available on request.

### Copyrights

© All rights reserved. No part of this publication may be reproduced, stored in a retrieval system, or made public, in any form or by any means, either graphic, electronic or mechanical, including photocopying, recording or otherwise, without the prior written permission of Trespa International BV.

[www.trespa.com](http://www.trespa.com)



All the best qualities in one panel



U233

Your Trespa distributor: